

ORIGINAL MINI ACCESSORIES. INSTALLATION INSTRUCTIONS.



Rear Spoiler Retrofit Kit

MINI Coupé (R 58)

MINI Convertible (R 59)

Retrofit kit number

51 62 2 218 750 John Cooper Works Rear Spoiler R 58

51 62 2 218 751 John Cooper Works Rear Spoiler R 59

Installation time

The installation time is **approx. 1.0 hour**. This may vary, depending on the condition of the car and the equipment in it.

The installation time specified does not include time spent on programming/coding.

The charging of all costs relating to the programming time must be taken into account in the calculation of the retrofit costs (billing via warranty is not permissible).

Important information

These installation instructions are intended for use only within the BMW dealership organisation and by authorised MINI service companies.

In any event, the target group for these installation instructions is specialist personnel trained on MINI cars with the appropriate specialist knowledge.

All work must be completed using the latest MINI repair manuals, wiring diagrams, servicing manuals and work instructions, in a rational order, using the prescribed tools (special tools) and observing current health and safety regulations.

If you experience installation or function problems, restrict troubleshooting to approx. 0.5 hours for mechanical work and 1.0 hour for electrical work.

To avoid unnecessary extra work and/or costs, an inquiry is to be sent straight away to the technical parts support via the After Sales Assistance Portal (ASAP).

Quote the following information:

- Chassis number,
- Retrofit kit part number,
- A detailed description of the problem,
- Any work already carried out.

Do not archive the hard copy of these installation instructions since daily updates are made via ASAP!

Pictograms

 Denotes instructions that draw your attention to dangers.

 Denotes instructions that draw your attention to special features.

◀ Denotes the end of the instruction or warning text.

Installation information

All pictures show LHD cars; proceed accordingly on RHD cars.

When delivered, the upper section **A** of the rear spoiler and the lower section **B** of the rear spoiler are screwed together with both screws **C**. The two screws **C** must be loosened before painting. Screws **C** will be reused for later assembly.

Painting recommendations:

The lower section of the rear spoiler can be painted in the same colour as the car, while the upper section of the rear spoiler can be painted in the colour of the car's roof.

Painting instructions for the primed version

Primed parts must be pre-treated accordingly. Follow the MINI painting instructions for all painting work.

Check that all the parts fit accurately on the car before painting them.

Thread surfaces must remain free from paint, while thread sleeves on the underside of the rear spoiler must remain on the threads until after painting is complete.

The car may be driven after approx. **6 hours** and may be taken through a car wash after **48 hours**.

Ordering instructions

The following parts are not included with the retrofit kit and must therefore be ordered separately (see EPC for part number and details).

1K Betalink	82 69 9 408 866
Instant adhesive	07 58 9 062 157

Optional (depending on the equipment in the car):

Silver lower section stripes R 58	51 14 2 759 318
Black lower section stripes R 58	51 14 2 759 317
Red lower section stripes R 58	51 14 2 759 319
Silver lower section stripes R 59	51 14 2 759 670
Black lower section stripes R 59	51 14 2 759 699
Red lower section stripes R 59	51 14 2 759 671

Special tools required for application of the stripes

- Blade (part number 51 91 0 416 502)
- Application fluid (part number 51 91 0 416 506)
- Spray bottle

Table of contents

Section	Page
1 Parts list	4
2 Preparatory work	5
3 Installing the rear spoiler	6
4 Concluding work and coding	10

1. Parts list

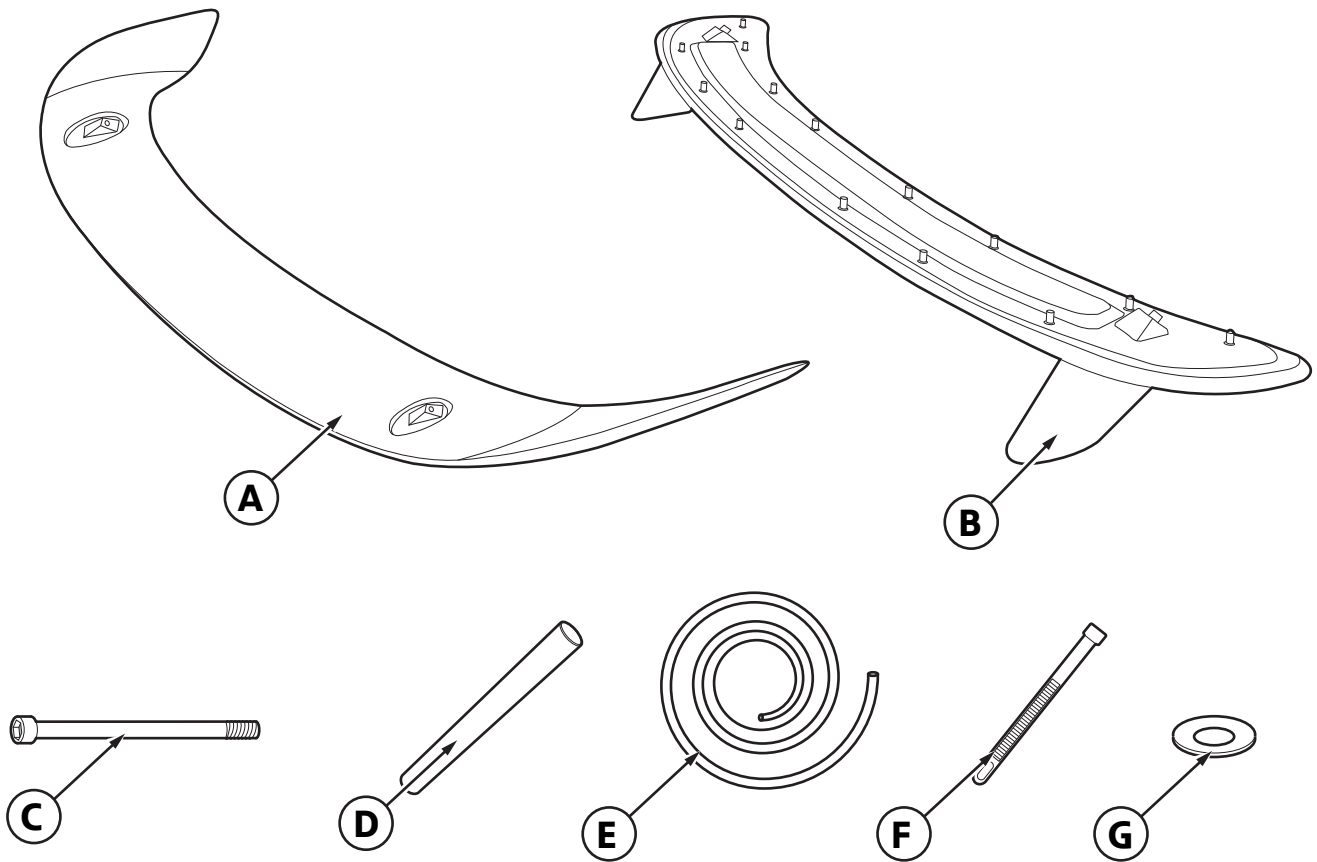

R58 0020 V

Legend

- A** Rear spoiler upper section*
- B** Rear spoiler lower section*
- C** Screw (2 x)*
- D** Spacer sleeve (2 x)
- E** Sealing cord
- F** Cable tie (3 x)
- G** Shim (2 x)

* When delivered, the upper section **A** of the rear spoiler and the lower section **B** of the rear spoiler are screwed together with both screws **C**. The two screws **C** must be loosened before painting. Screws **C** will be reused for later assembly.

2. Preparatory work

The following components must be removed first of all	ISTA No.
Disconnect the car battery	---
Tailgate trim	51 49 000
Series rear spoiler	51 71 412

3. Installing the rear spoiler

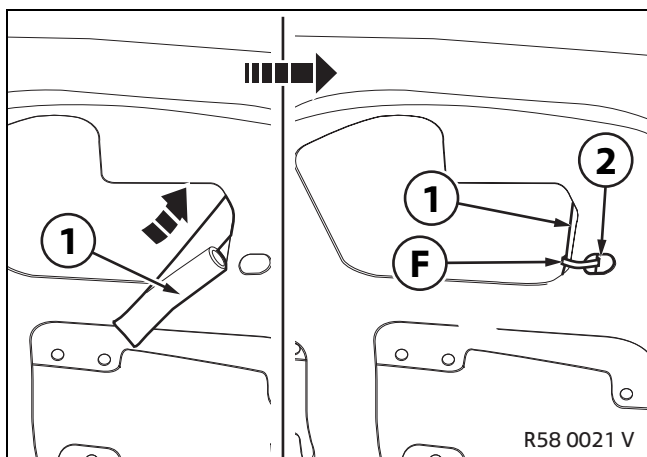

Bend both water outlet hoses (1) and secure using cable tie **F** to the cavity on the drill hole (2).

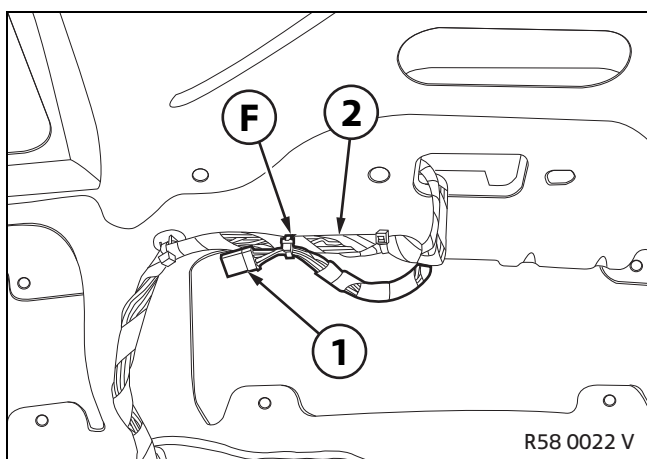

Bend the cable end with plug (1), route along cable (2) and secure in place with cable tie **F**.

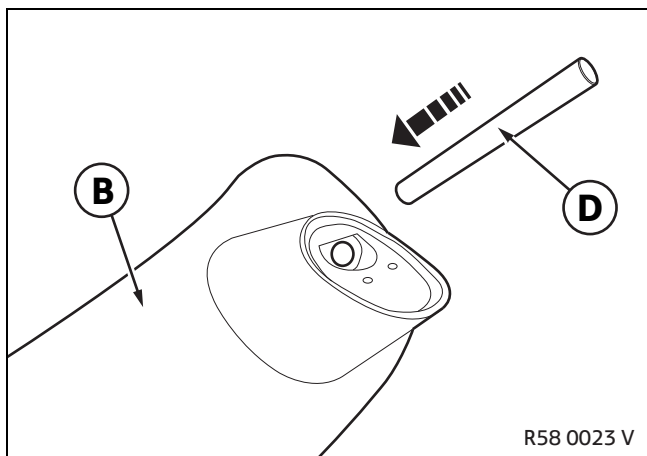

Introduce spacer sleeve **D** into the opening of rear spoiler lower section **B**.

☐ Ensure all edges are flush. ◀

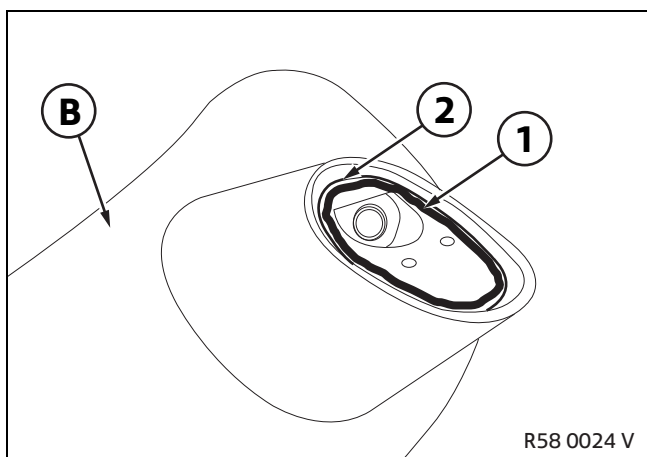

☐ The area being bonded must be completely dry, clean and free from wax or grease. ◀

Apply Betalink (1) with a diameter of **3–4 mm** into the inner gap (2) of rear spoiler lower section **B**.

☐ Remove any residual Betalink adhesive (1) immediately. ◀

3. Installing the rear spoiler

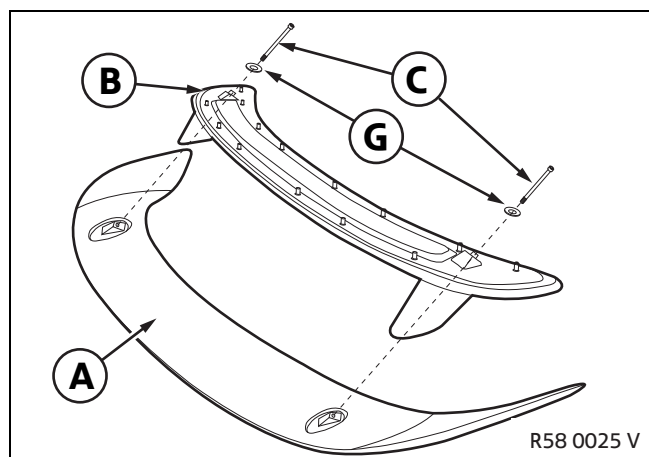

Place rear spoiler lower section **B** on rear spoiler upper section **A**. Introduce screws **C** from underneath together with shim **G** and tighten to **5 Nm**.

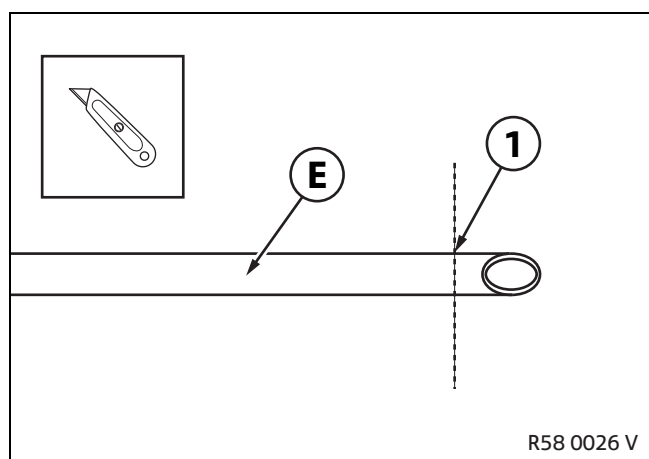

Cut sealing cord **E** perpendicularly at one end (1) using a suitable tool.

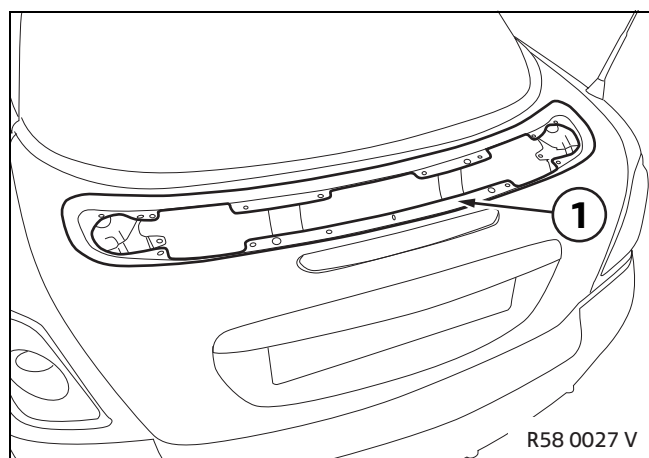

 The area being bonded must be completely dry, clean and free from wax or grease. ◀

Clean the surfaces of the depression (1) with suitable agents.

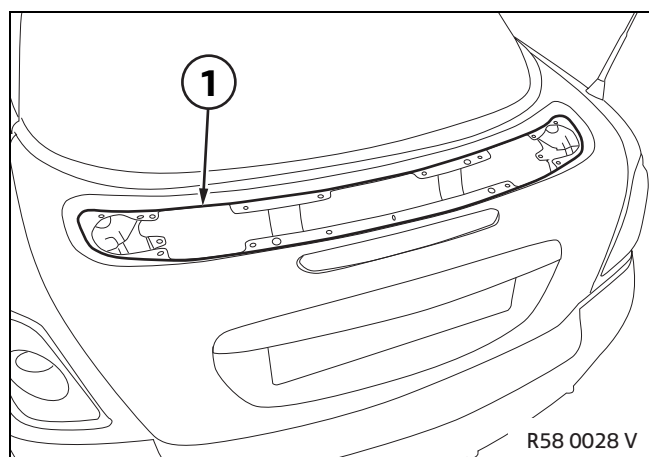

Apply an even, thin bead of instant adhesive along the depression (1).

3. Installing the rear spoiler

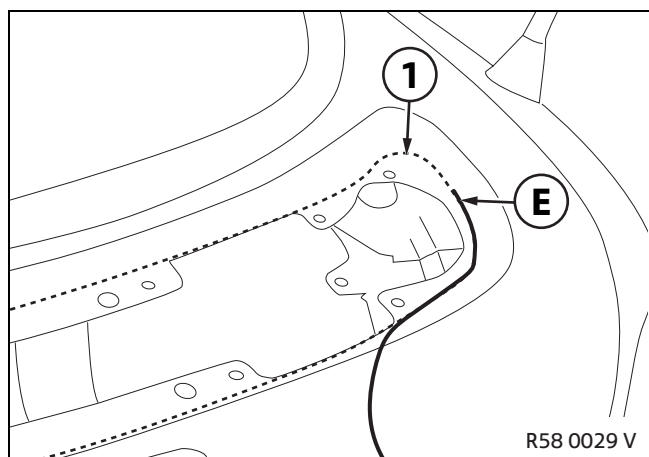

Along the line of instant adhesive (1), starting from the narrow side, align and press on sealing cord E.

▶ Do not compress or stretch sealing cord E. ◀

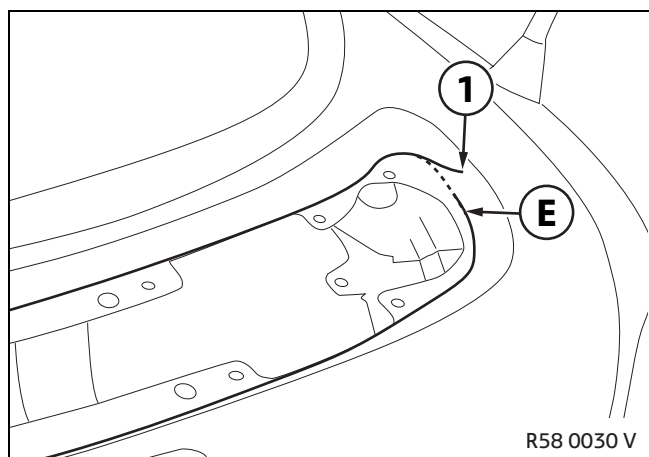

Cut sealing cord E perpendicularly at the abutting edge (1). Apply the instant adhesive to the abutting edge (1). Press both ends of sealing cord E together and bond so they are flush.

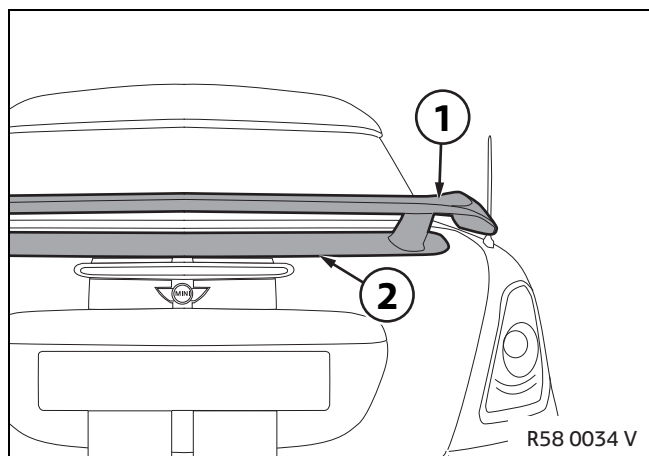

Place rear spoiler upper section and lower section (1) onto the tailgate while the tailgate is closed.

▶ Check the position of the gap (2) on the rear spoiler lower section in relation to the tailgate and correct if necessary, so that the appearance of an even gap (2) is created. ◀

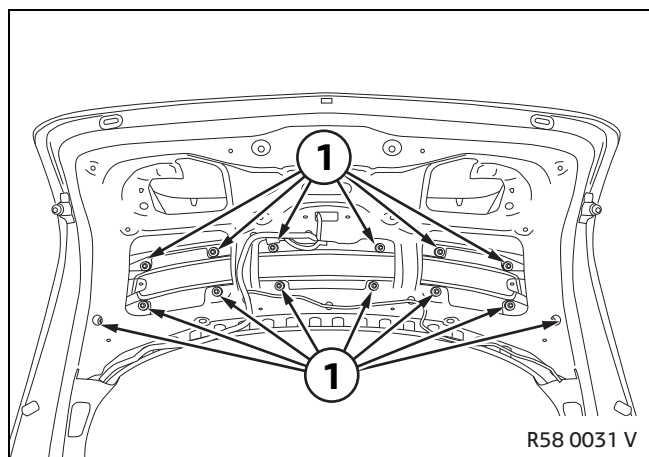

With the tailgate open, screw the 14 screws on the rear spoiler from inside using the existing nuts with washers (1) to **5 Nm** from the inside to the outside.

3. Installing the rear spoiler

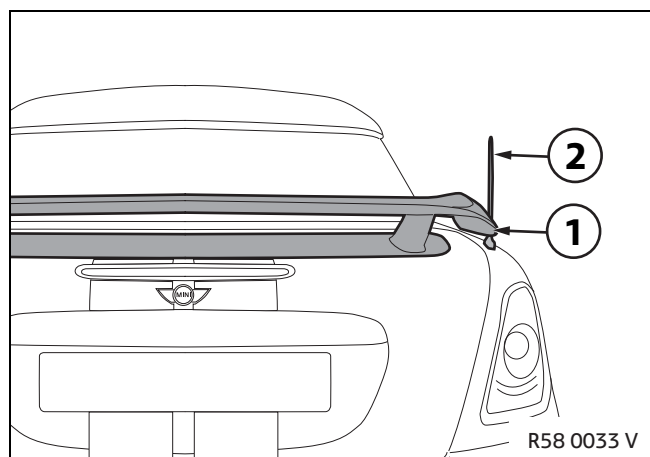

☐ Check there is free accessibility between the rear spoiler (1) and the antenna (2) when opening the tailgate. Adjust the position of the antenna (2) if necessary as per **ISTA No. 65 20 060**. ◀

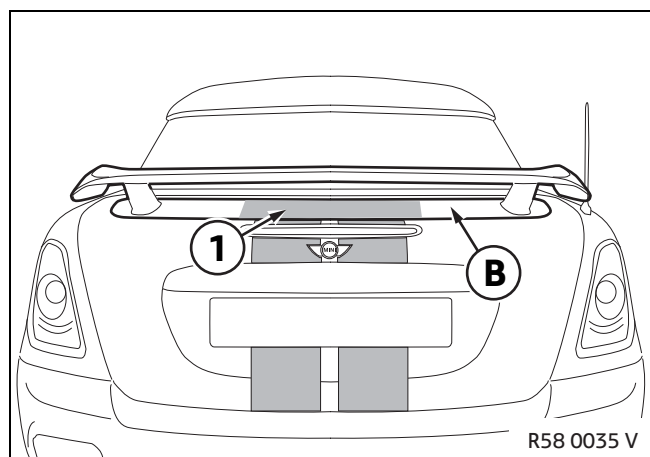

Only for cars with decals:

☐ The lower section stripe must be ordered separately (for instructions and part numbers, see page 2 of the ordering instructions or the EPC).

The surface (1) on rear spoiler lower section **B** must be completely dry, clean and free from wax or grease.

The surface on the rear spoiler lower section (1) must be sprayed fully and generously with installation solution.

The adhesive side of the lower section stripe is covered with a printed protective film. Carefully remove the protective film from the lower section stripe at an angle of 180°. As you do so, thoroughly wet the adhesive side with installation solution. ◀

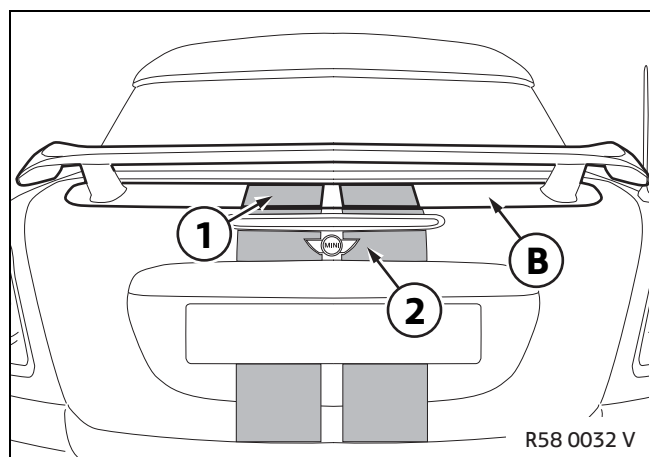

Place the lower section stripe (1) on rear spoiler lower section **B** and align with the existing stripes (2), centre, press into place and run the blade over it.

Spray the application tape of lower section stripe (1) with installation solution and remove it carefully after **around 5 mins**.

4. Concluding work and coding

The retrofit system requires coding.

- Fit the tailgate trim as per **ISTA No. 51 49 000**.
- Connect the battery
- Code the retrofit with ISSS (Integrated Software Service Station) via the – **+SFIX** – path
- Conduct a brief test