

ORIGINAL MINI ACCESSORIES. INSTALLATION INSTRUCTIONS.



Aerodynamics Package Retrofit Kit MINI Countryman (R 60)

Retrofit kit number

51 19 2 180 855	Aerodynamics package primed
51 19 2 180 856	Aerodynamics package painted
51 19 2 210 567	Aerodynamics package painted
51 19 2 212 129	Aerodynamics package painted

Installation time

The installation time is **approx. 2.5 hours**. This may vary depending on the condition of the car and the equipment in it.

Important information

These installation instructions are primarily designed for use within the BMW dealership organisation and by authorised MINI service companies.

In any event the target group for these installation instructions is specialist personnel trained on MINI cars with the appropriate specialist knowledge.

All work must be completed using the latest MINI repair manuals, wiring diagrams, servicing manuals and work instructions, in a rational order, using the prescribed tools (special tools) and observing current health and safety regulations.

If you experience installation or function problems, restrict troubleshooting to approx. 0.5 hours for mechanical work and 1.0 hour for electrical work.

To avoid unnecessary extra work and/or costs, an inquiry is to be sent straight away to the technical parts support via the After Sales Assistance Portal (ASAP).

Quote the following information:

- Chassis number,
- Retrofit kit part number,
- A detailed description of the problem,
- Any work already carried out.

Do not archive the hard copy of these installation instructions since daily updates are made via ASAP!

Pictograms



Denotes instructions that draw your attention to dangers.



Denotes instructions that draw your attention to special features.

◀ Denotes the end of the instruction or warning text.

Installation information

All pictures show LHD cars; proceed accordingly on RHD cars.

Painting instructions for the primed version

Primed parts must be pre-treated accordingly. Follow the MINI painting instructions for all painting work.

Check that all the parts fit accurately on the car before painting them.

Remove the primed upper sill section of the black lower sill section.

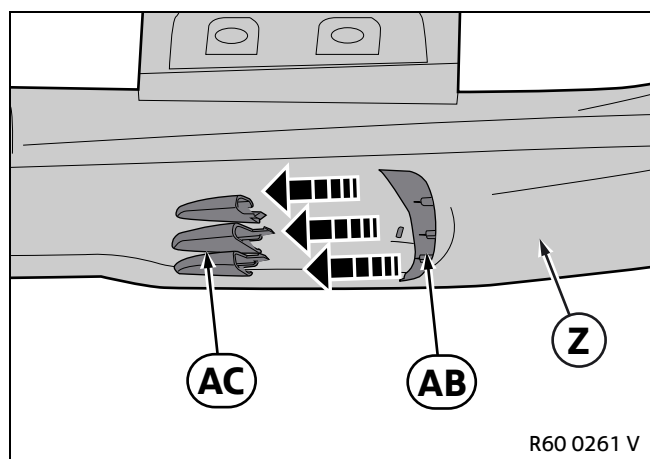

To paint the right/left sill cover **Z**, the left/right sill air inlet inserts **AC** must first be removed from the left/right sill air inlet support section **AB**.

Then remove the left/right sill air inlet support sections **AB** from the left/right sill cover **Z**.

Instructions to be provided to the customer

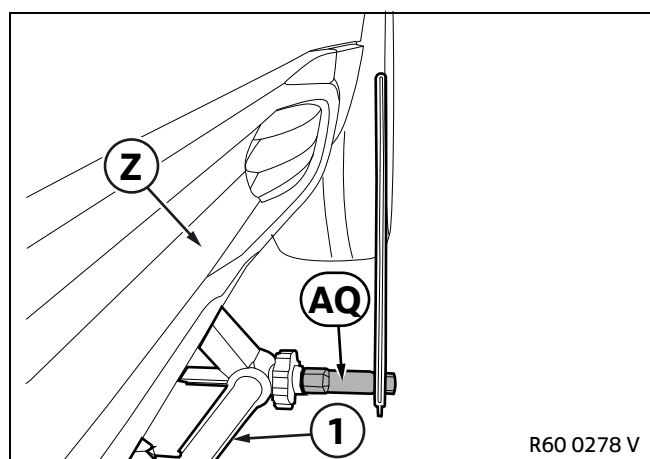

▶ To avoid a collision with the left/right sill cover **Z** when changing tyres, the side skirt trim parts kit includes an extension piece **AQ** for the Original BMW car jack (1). ◀

Special tools required

None

Table of contents

Section	Page
1 Front spoiler parts list	4
2 Rear spoiler parts list	5
3 Side skirt trim parts list	6
4 Preparatory work	7
5 Installing the front spoiler	8
6 Installing the rear spoiler	10
7 Installing the side skirt trim	14
8 Concluding work and coding	18

1. Front spoiler parts list

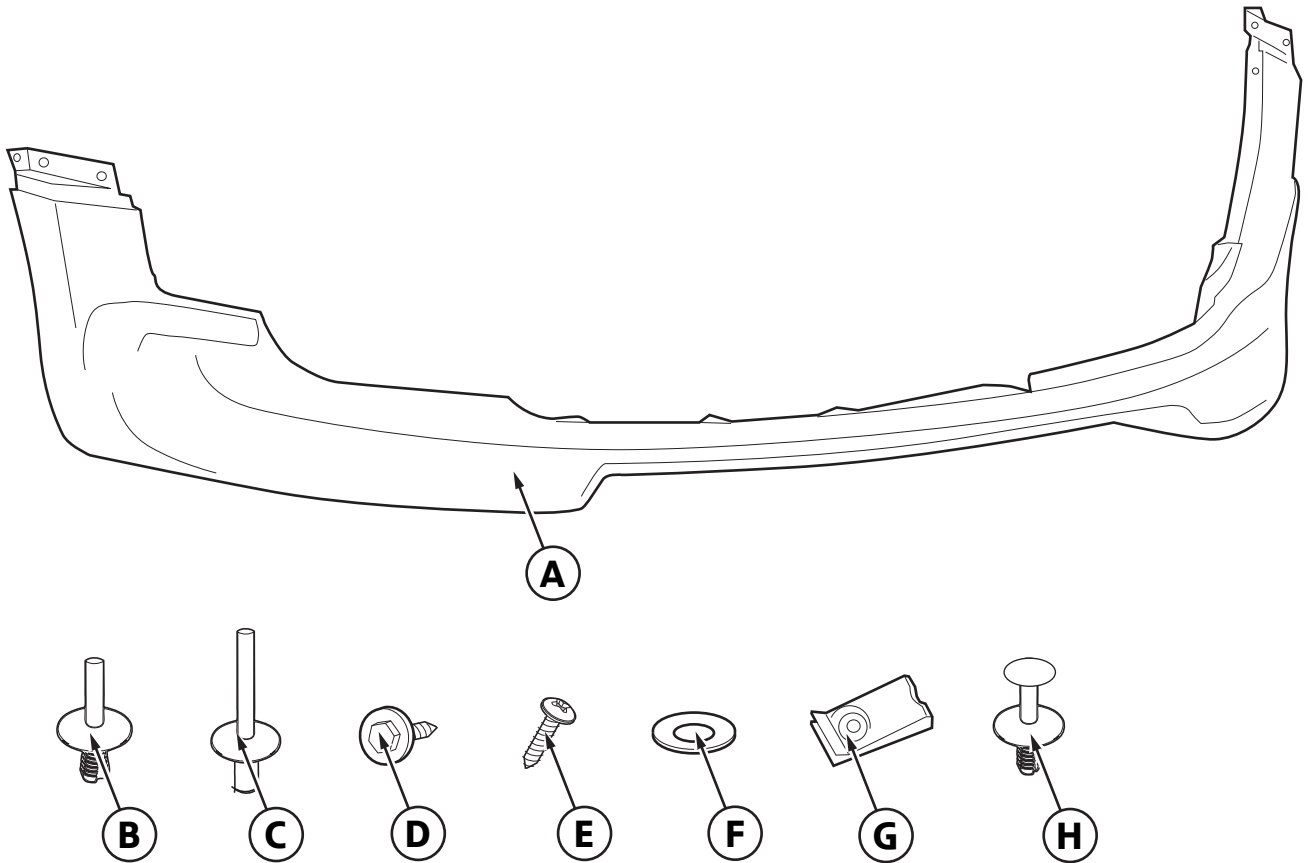

R60 0279 V

Legend

- A** Front spoiler
- B** Expanding rivet (4 x)
- C** Blind rivet (4 x)
- D** Hexagon sheet metal screw (10 x)
- E** Phillips head screw for plastic, long (5 x)
- F** Shim (3 x)
- G** Sheet metal nut, long (3 x)
- H** Attachment plugs (2 x)

2. Rear spoiler parts list

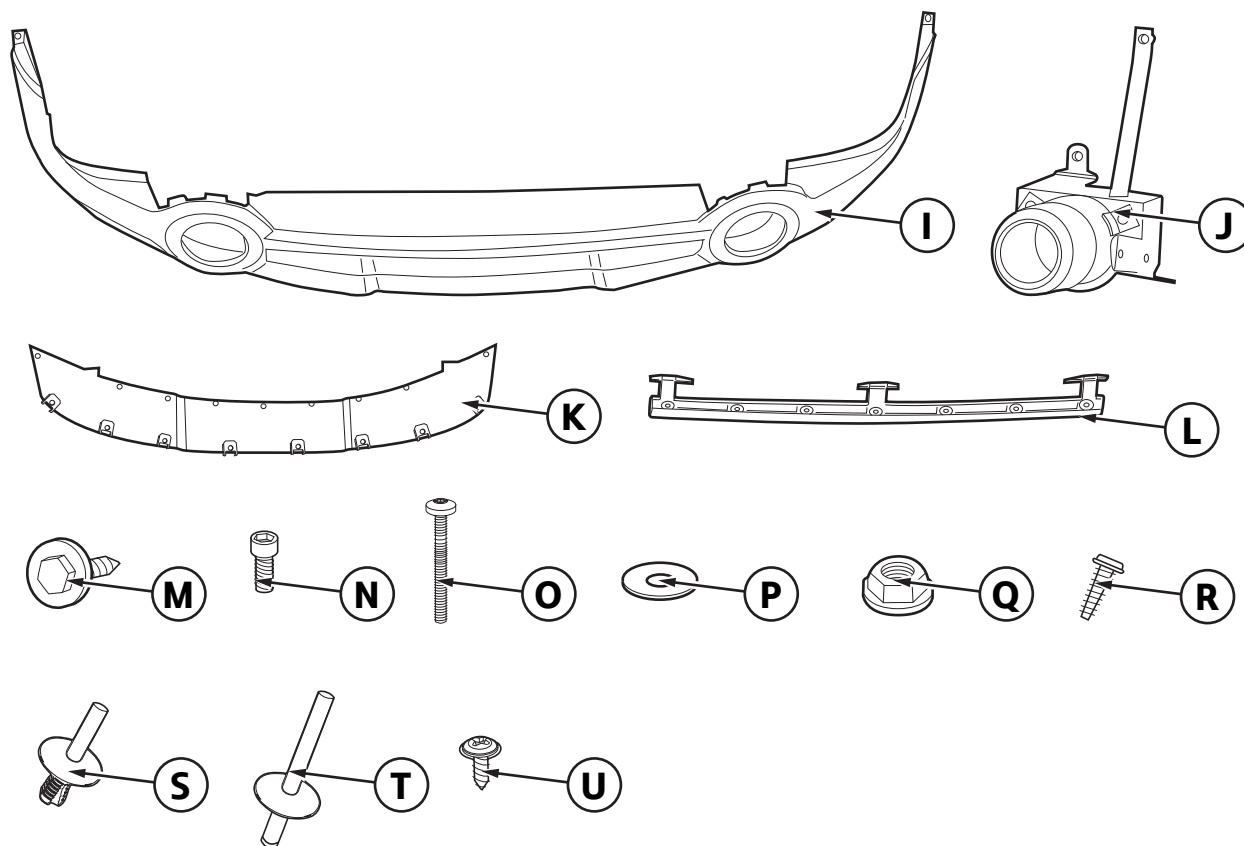

R60 0281 V

Legend

- I** Rear spoiler
- J** Assembly of the tailpipe finisher (2 x)
- K** Lower diffuser insert
- L** Rear spoiler adapter
- M** Hexagon sheet metal screw (4 x)
- N** Allen screw M6 x 20 (4 x)
- O** Screw 4.8 x 45 (2 x)
- P** Shim (17 x)
- Q** Plastic nuts (2 x)
- R** Inside torx screw 4 x 10 (15 x)
- S** Expanding rivet (4 x)
- T** Blind rivet (4 x)
- U** Screw for thermoplastic plastics (7 x)

3. Side skirt trim parts list

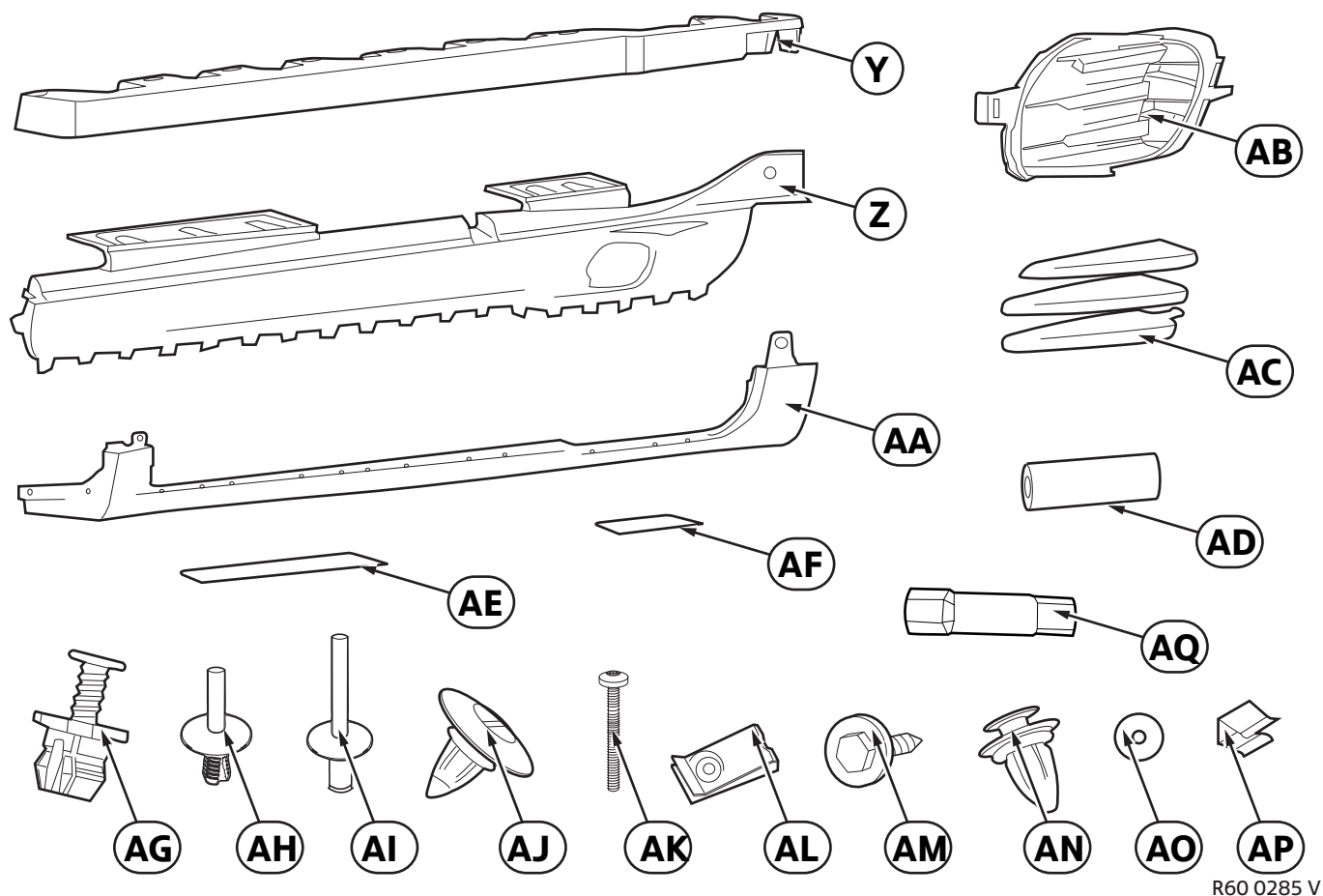

R60 0285 V

Legend

- Y** Left/right sill adapter (2 x)
- Z** Left/right sill cover (2 x)
- AA** Black Band sill left/right (2 x)
- AB** Left/right sill air inlet support section (2 x)
- AC** Left/right sill air inlet insert (6 x)
- AD** Spacer (2 x)
- AE** Front left/right entrance finisher (2 x)
- AF** Rear left/right entrance finisher (2 x)
- AG** Expanding rivet (4 x)
- AH** Expanding rivet (4 x)
- AI** Blind rivet (2 x)
- AJ** Clip (26 x)
- AK** Screw 4.8 x 45 (2 x)
- AL** Sheet metal nut, long (2 x)
- AM** Hexagon sheet metal screw (22 x)
- AN** Clip (16 x)
- AO** Shim (2 x)
- AP** Sheet metal clamp (8 x)
- AQ** Extension piece for car jack

4. Preparatory work

	ISTA No.
Conduct a brief test	---
Disconnect the negative pole of the battery	12 00 ...
The following components must be removed first of all	
Sill trim	51 11 ...
Front bumper	51 11 156
Rear bumper	51 12 156
Left/right rear bottom guide	---
Rear RDC/TPM antenna	---

5. Front spoiler installation

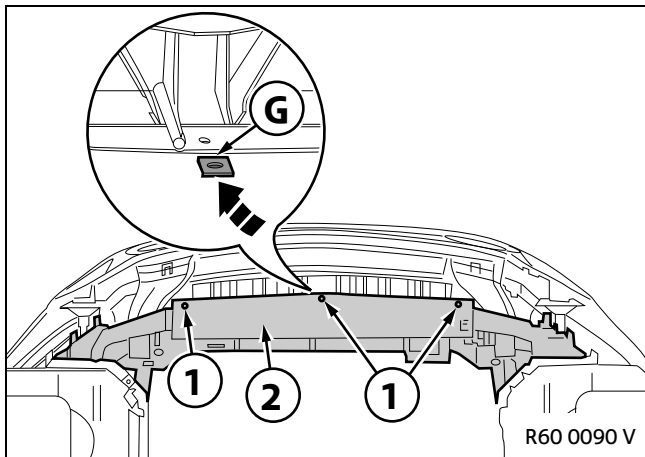

Place the 3 long sheet metal nuts **G** onto the drill holes (1) on the edge of the front panel (2).

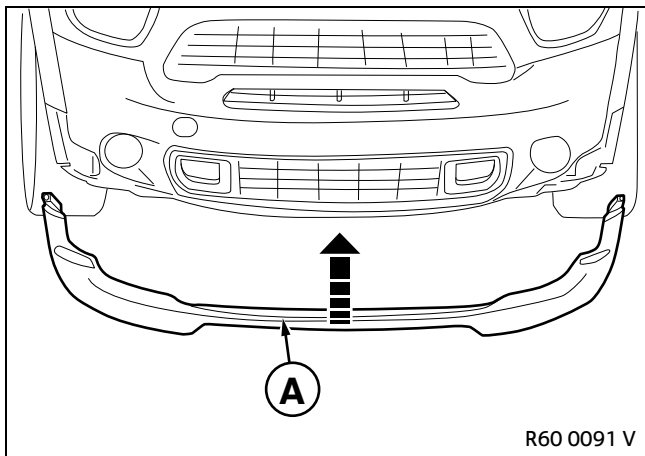

Place front spoiler **A** on the bumper from the front and allow it to engage.

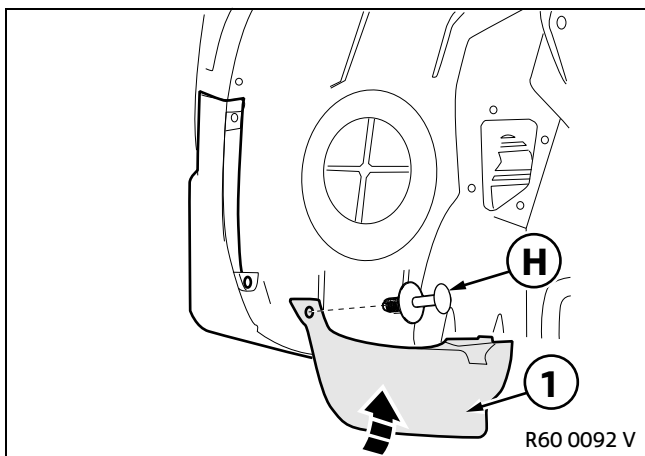

Lift the air guide (1) upwards and secure with attachment plugs **H**.

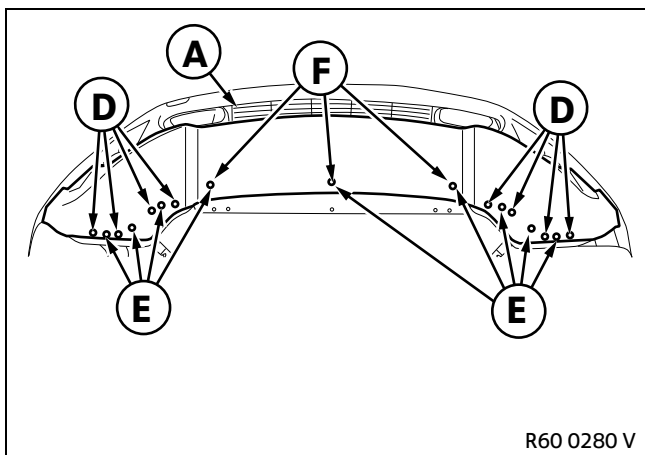

Screw front spoiler **A** onto the car. To do this, mate Philips head screws, long **E** with sheet metal nuts, long **G** (not shown).

Also, in the centre, screw long Philips head screws **E** into place using shims **F**.

Screw hexagon sheet metal screws **D** into place.

5. Front spoiler installation

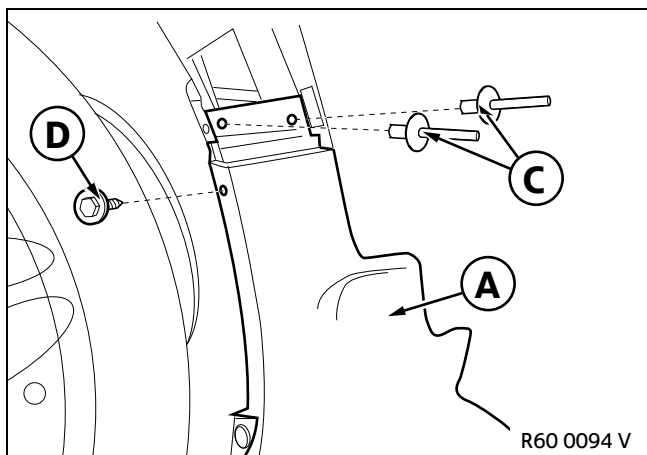

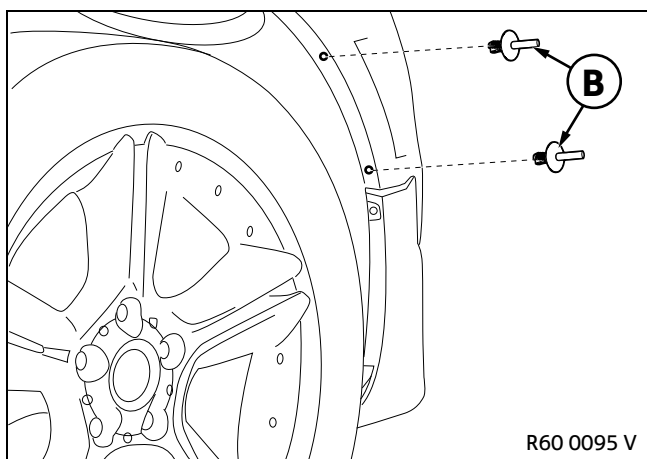

Rivet the sides of front spoiler **A** using both blind rivets **C** and screw hexagon sheet metal screw **D** into place.

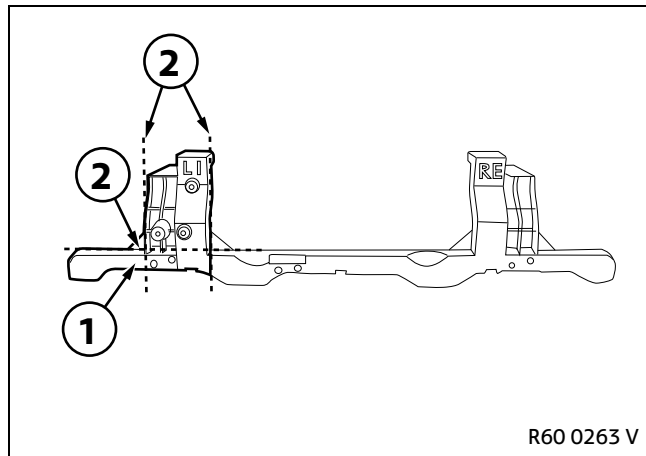

Place the existing expanding rivets (1) into the wheel arch, replacing any faulty expanding rivets with expanding rivets **B**.

6. Installing the rear spoiler



 The RDC/TPM antenna must be removed before cutting. ◀

For cars with RDC/TPM or all US cars:

Cut the left rear bottom guide (1) along the edges (2) using a suitable tool and deburr.

Fit the RDC/TPM antenna onto the car onto both drill holes of the left bottom rear guide (1) and fit left bottom rear guide (1) back onto the car using the existing parts.

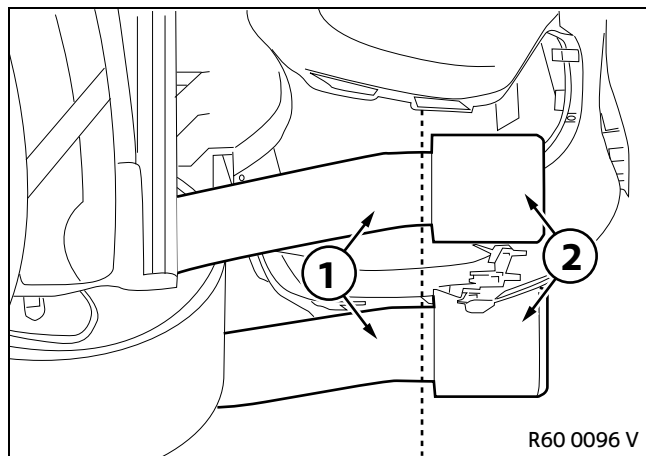

Separate the exhaust pipe (1) directly after the tailpipe finishers (2) using a suitable tool and deburr.

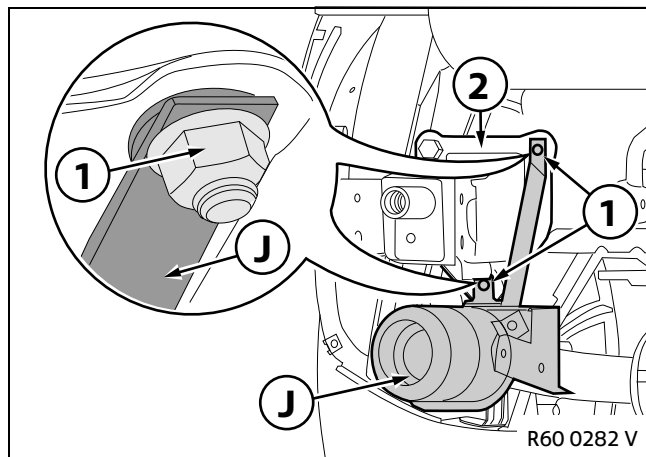

Remove the nuts (1) from the drill hole of the crash support (2). Fit tailpipe finisher assembly J and tighten with the existing nuts (1).

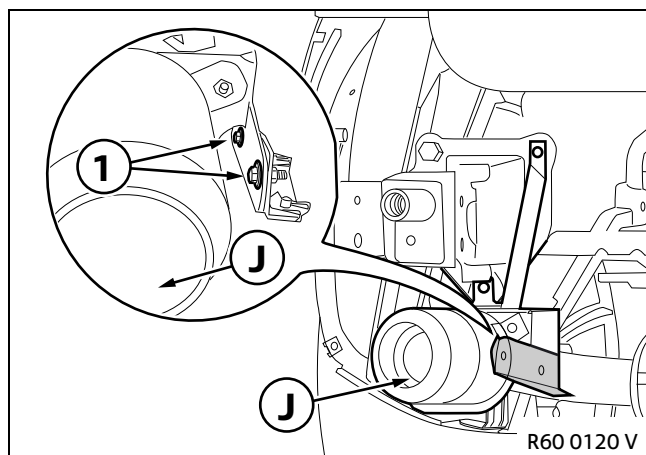

Loosen the two screws (1) on tailpipe finisher assembly J.

6. Installing the rear spoiler

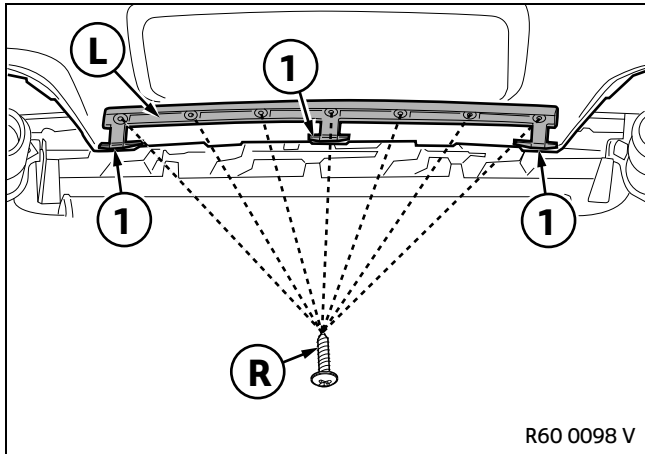

Position rear spoiler adapter **L** so that the positioning aids (1) fit into the edge of the bumper (2). Tighten rear spoiler adapter **L** into position using the seven oval-head screws **R**.

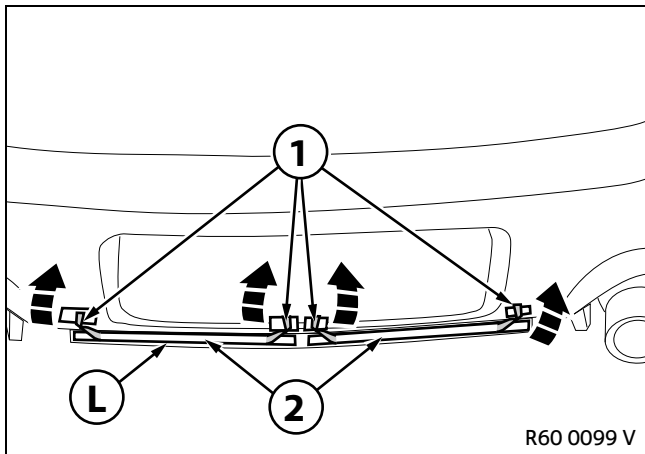

Loosen the ends of the protective film (1) on the adhesive strip (2) on rear spoiler adapter **L** and secure with adhesive tape.

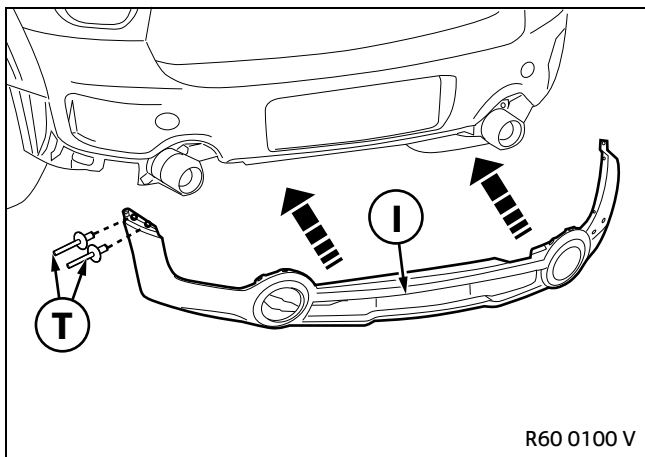

Place rear spoiler **I** from the back onto the rear apron until it engages.

Rivet rear spoiler **I** to the sides using blind rivets **T**.

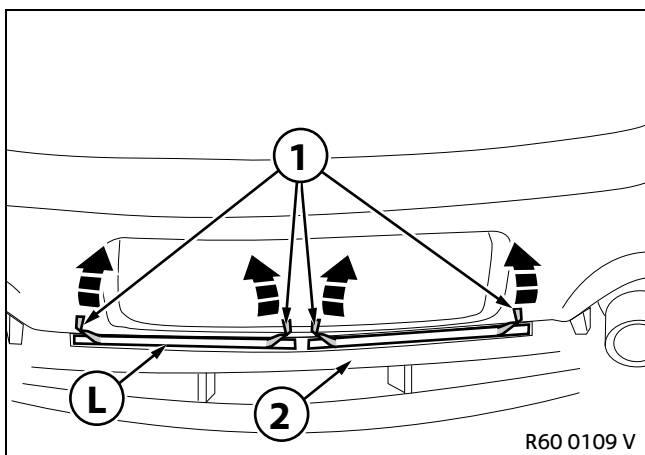

Fully remove the protective film (1) on the adhesive strips and press the spoiler (2) firmly onto rear spoiler adapter **L**.

6. Installing the rear spoiler

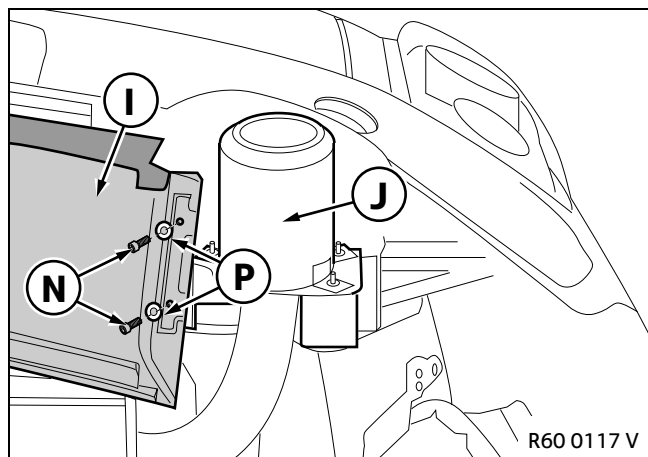

Screw tailpipe finisher assembly **J** using two Allen screws **N** and two shims **P** to rear spoiler **I**.

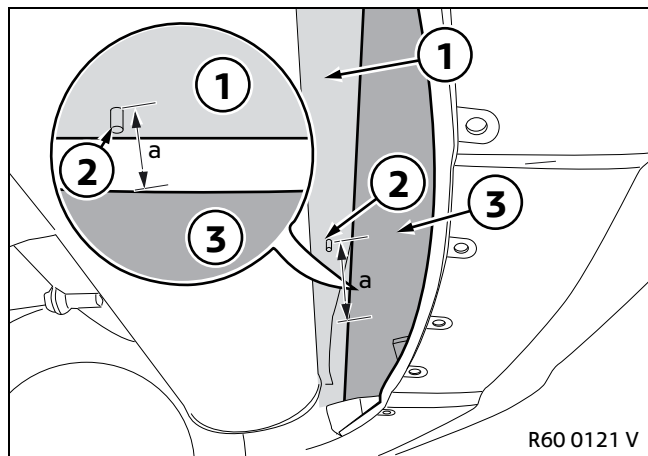

The distance from the surface (1) with the pins (2) to the edge of the diffuser (3) must be **a = 176 mm** on both sides.

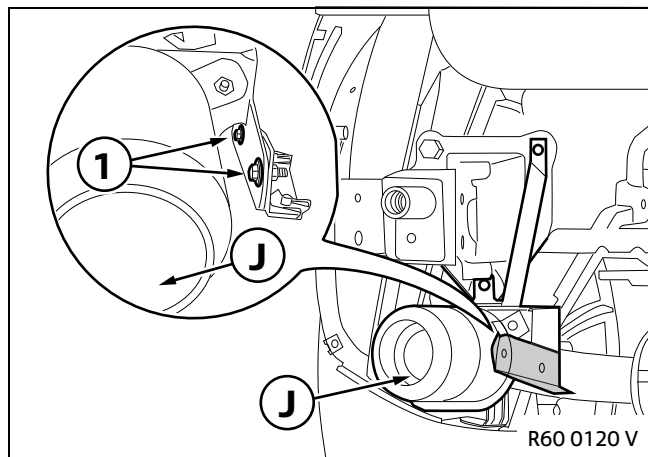

Tighten the loosened screws (1) on tailpipe finisher assembly **J**.

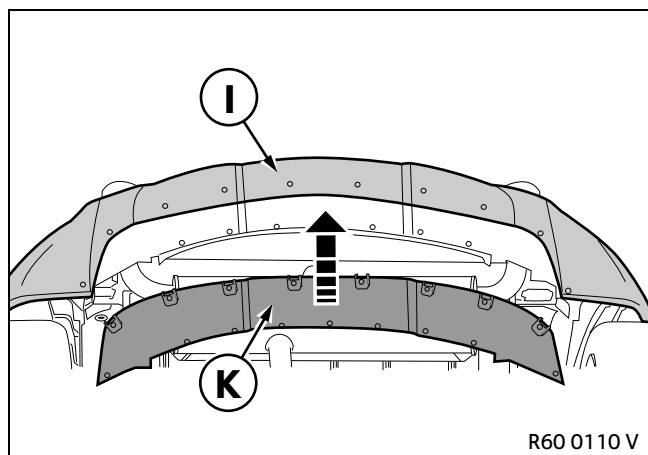

Plug lower diffuser insert **K** from underneath into rear spoiler **I**.

6. Installing the rear spoiler

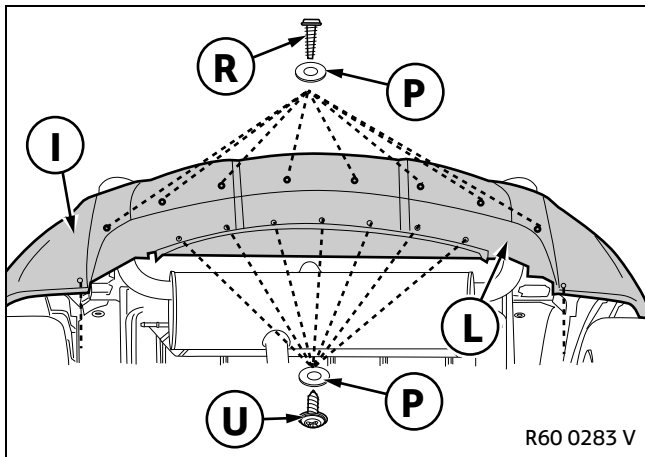

Screw rear spoiler **I** using oval-head screws **R** and shims **P** together with lower diffuser insert **K** into the sheet metal nuts (not shown).

Then mate the screws for thermoplastic plastic **U** with shims **P**.

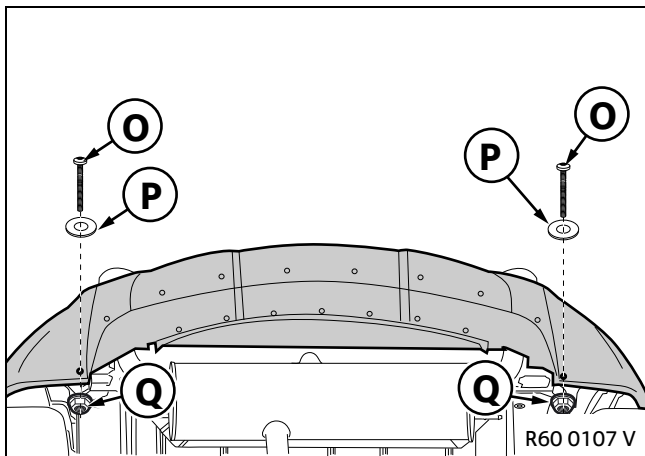

Screw screw **O** together with shim **P** from the outside into plastic nut **Q**.

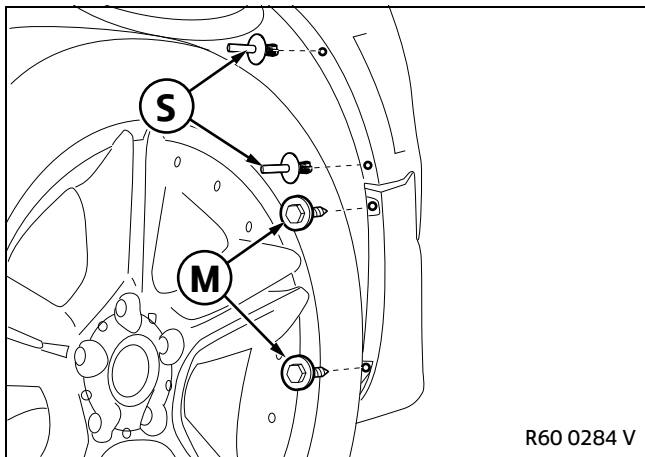

Screw hexagon sheet metal screws **M** into the wheel arch.

Place the expanding rivet in the wheel arch, replacing any damaged expanding rivets with expanding rivet **S**.

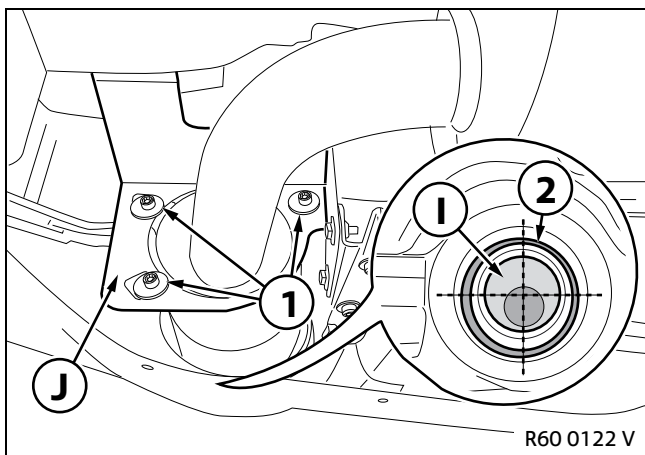

Loosen the three screws (1) on tailpipe finisher assembly **J**. Align the tailpipe finisher (2) centrally to the opening of rear spoiler **I** and tighten the screws (1).

7. Installing the side skirt trim

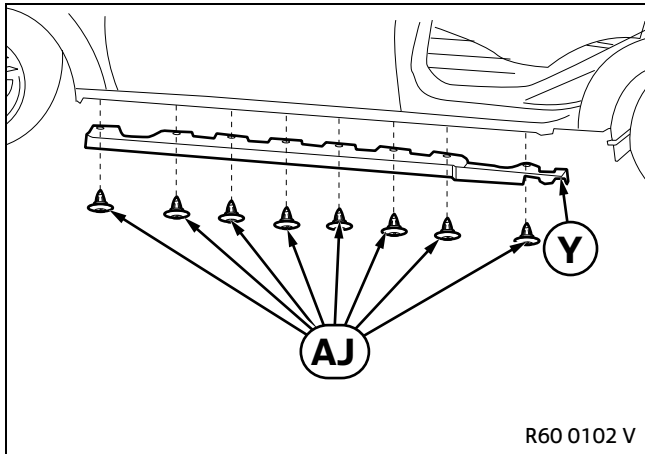

Secure sill adapter **Y** using clips **AJ** to the car's bodywork.

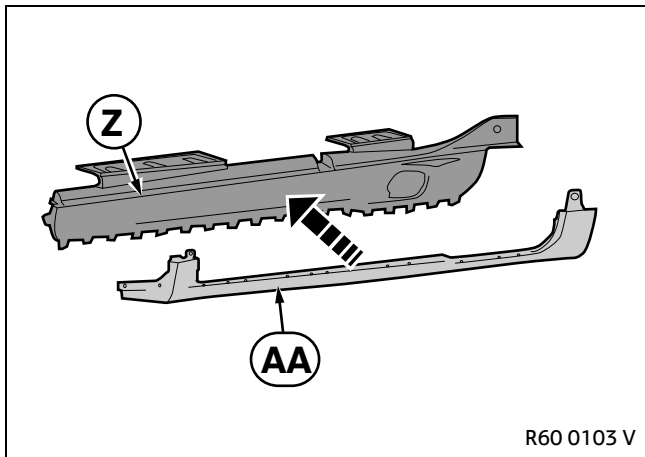

Place Black Band sill **AA** onto sill cover **Z**.

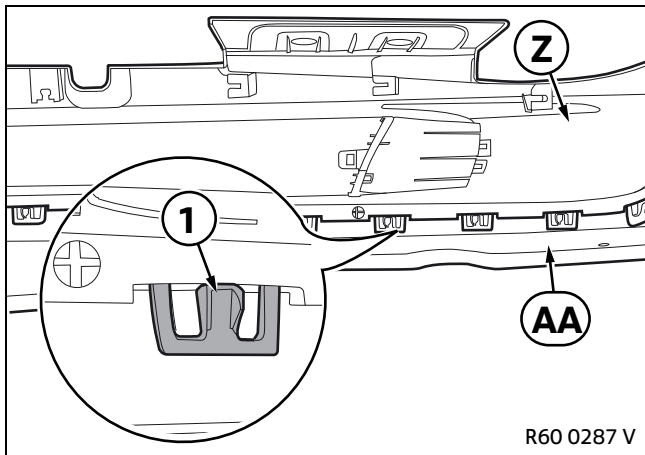

☐ The locking lugs (1) of sill cover **Z** must be clearly engaged in the openings of Black Band sill **AA**. ◀

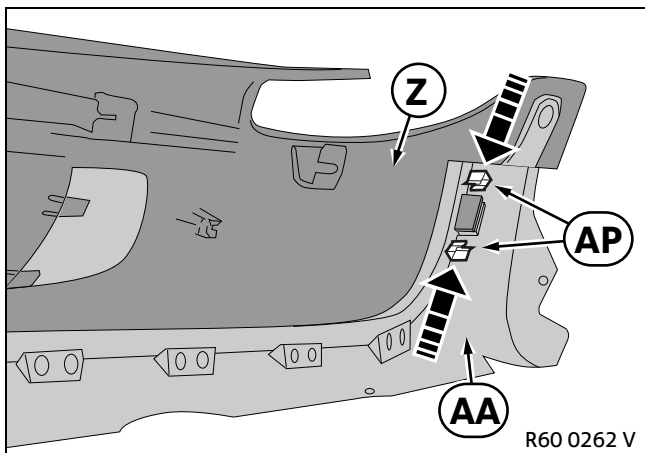

Insert two sheet metal clamps **AP** at the front and two at the rear onto the lug of Black Band sill **AA** and sill cover **Z**.

7. Installing the side skirt trim

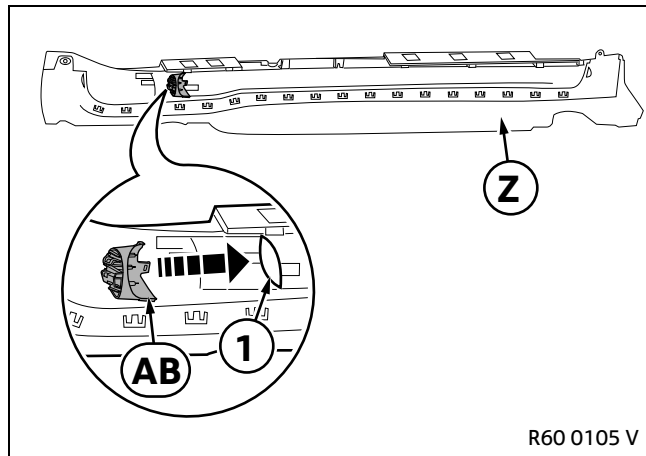

Insert sill air inlet support section **AB** into the cut-out opening (1) of sill cover **Z** and allow it to engage.

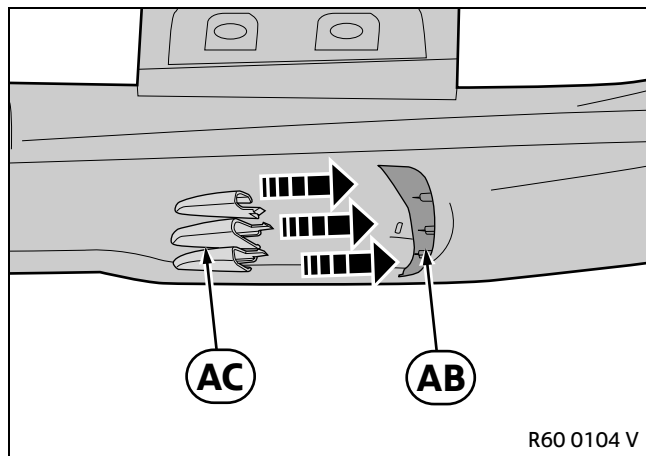

Plug sill air inlet insert **AC** into sill air inlet support section **AB**.

The inserts are numbered and are inserted as follows:

- L1 - top left
- L2 - centre left
- L3 - bottom left
- R1 - top right
- R2 - centre right
- R3 - bottom right

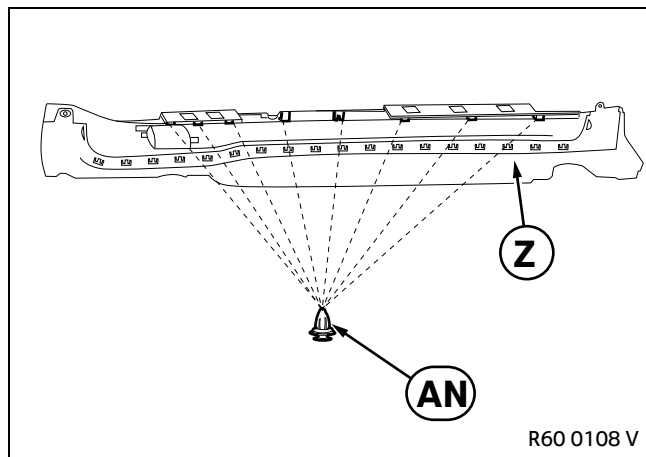

Fit the eight clips **AN** at the points indicated on sill cover **Z**.

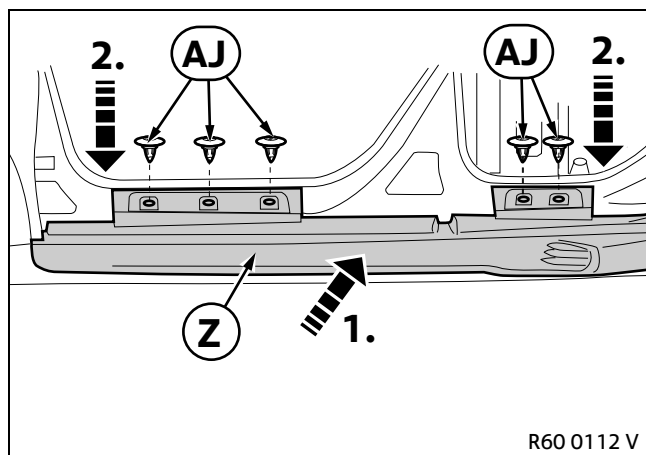

Fit sill cover **Z** using the eight clips **AN** (not shown) to the car.

Fit the five clips **AJ** on the top of sill cover **Z**.

7. Installing the side skirt trim

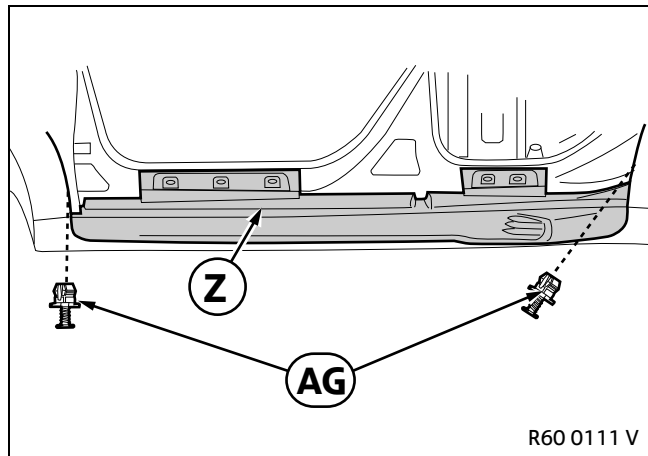

Fit the front and rear expanding rivet **AG** of sill cover **Z**.

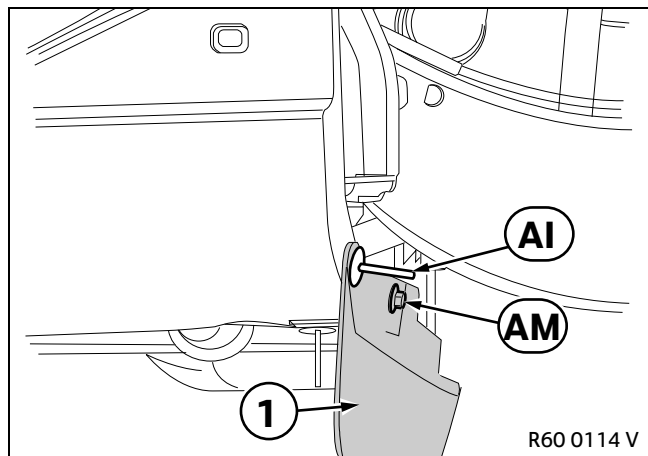

Fit on the air guide (1). Rivet blind rivet **AI** and screw hexagon sheet metal screw **AM**.

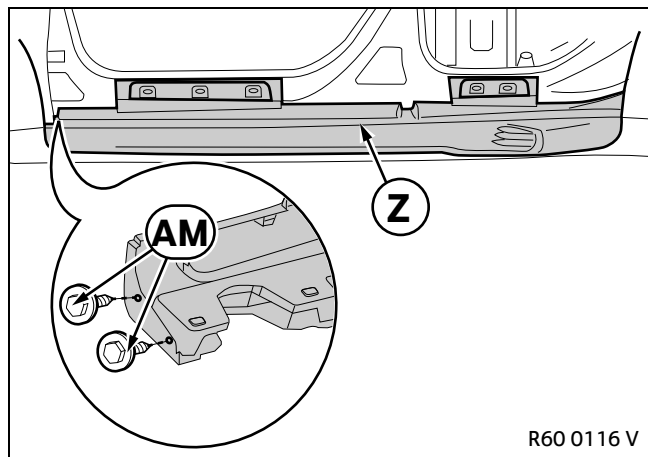

Tighten sill cover **Z** on both narrow sides using hexagon sheet metal screws **AM**.

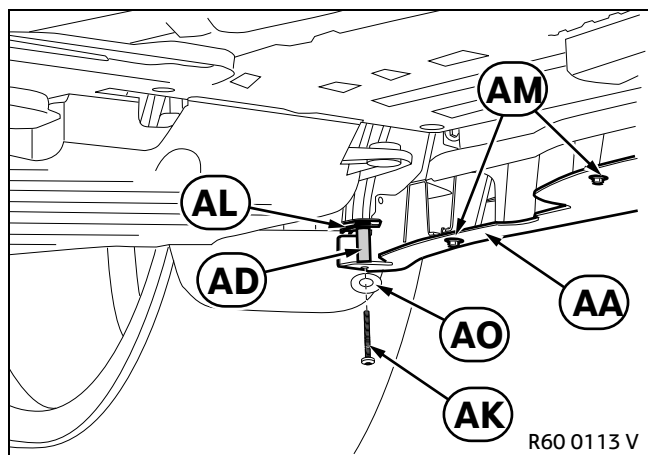

First fit on sheet metal nut **AL**. Place screw **AK** from underneath together with shim **AO** through spacer **AD** and screw into sheet metal nut **AL**.

Then screw the 6 hexagon sheet metal screws **AM** to Black Band sill **AA**.

7. Installing the side skirt trim

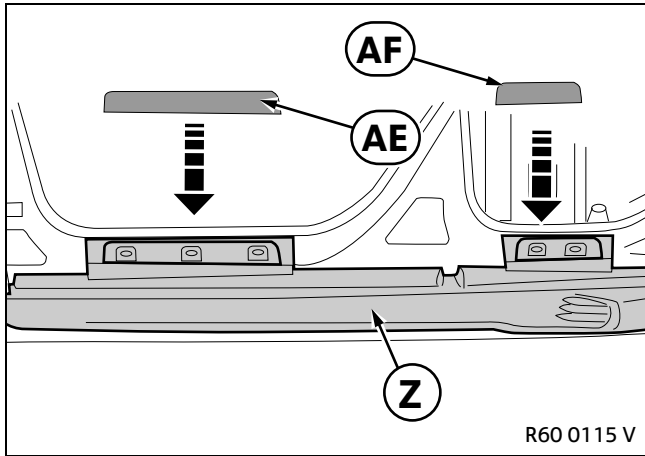

Stick front entrance finisher **AE** and rear entrance finisher **AF** onto sill cover **Z**.

8. Concluding work and coding

This retrofit system does not require coding.

- Connect the battery
- Conduct a brief test

Re-fit the car components as required.