

# Original MINI Accessories. Installation Instructions.



## JCW Aerodynamic Package Retrofit

**MINI One Clubman (R55)**  
**MINI Cooper Clubman (R55)**  
**MINI Cooper S Clubman (R55)**  
**MINI Cooper D Clubman (R55)**

<b>Retrofit kit No.:</b>	51 19 2 156 733	Primed JCW Aerodynamics package retrofit kit, Cooper S with PDC
	51 19 2 156 734	Primed JCW Aerodynamics package retrofit kit, Cooper S without PDC
	51 19 2 156 735	Primed JCW Aerodynamics package retrofit kit, One with PDC
	51 19 2 156 735	Primed JCW Aerodynamics package retrofit kit, Cooper with PDC
	51 19 2 156 736	Primed JCW Aerodynamics package retrofit kit, One without PDC
	51 19 2 156 736	Primed JCW Aerodynamics package retrofit kit, Cooper without PDC
	51 19 2 156 737	Primed JCW Aerodynamics package retrofit kit, Cooper D with PDC
	51 19 2 156 738	Primed JCW Aerodynamics package retrofit kit, Cooper D without PDC
	51 19 2 156 739	Painted JCW Aerodynamics package retrofit kit, Cooper S with PDC
	51 19 2 156 740	Painted JCW Aerodynamics package retrofit kit, Cooper S without PDC
	51 19 2 156 741	Painted JCW Aerodynamics package retrofit kit, One with PDC
	51 19 2 156 741	Painted JCW Aerodynamics package retrofit kit, Cooper with PDC
	51 19 2 156 742	Painted JCW Aerodynamics package retrofit kit, One without PDC
	51 19 2 156 742	Painted JCW Aerodynamics package retrofit kit, Cooper without PDC
	51 19 2 156 743	Painted JCW Aerodynamics package retrofit kit, Cooper D with PDC
	51 19 2 156 744	Painted JCW Aerodynamics package retrofit kit, Cooper D without PDC
	51 19 2 161 745	Painted JCW Aerodynamics package retrofit kit, Cooper S with PDC
	51 19 2 161 747	Painted JCW Aerodynamics package retrofit kit, Cooper S with PDC
	51 19 2 161 748	Painted JCW Aerodynamics package retrofit kit, Cooper S with PDC
	51 19 2 161 749	Painted JCW Aerodynamics package retrofit kit, Cooper S with PDC
	51 19 2 161 750	Painted JCW Aerodynamics package retrofit kit, Cooper S with PDC
	51 19 2 161 751	Painted JCW Aerodynamics package retrofit kit, Cooper S with PDC
	51 19 2 161 752	Painted JCW Aerodynamics package retrofit kit, Cooper S with PDC
	51 19 2 161 753	Painted JCW Aerodynamics package retrofit kit, Cooper S with PDC
	51 19 2 161 754	Painted JCW Aerodynamics package retrofit kit, Cooper S with PDC
	51 19 2 161 755	Painted JCW Aerodynamics package retrofit kit, Cooper S with PDC
	51 19 2 161 790	Painted JCW Aerodynamics package retrofit kit, Cooper S without PDC
	51 19 2 161 791	Painted JCW Aerodynamics package retrofit kit, Cooper S without PDC
	51 19 2 161 792	Painted JCW Aerodynamics package retrofit kit, Cooper S without PDC
	51 19 2 161 793	Painted JCW Aerodynamics package retrofit kit, Cooper S without PDC

## Installation time

The installation time for the individual retrofit kits is around:

Car	Painted	Primed	PDC	Flat rate units
Cooper/One	X		X	21
Cooper/One	X			17
Cooper/One		X	X	24
Cooper/One		X		20
Cooper D	X		X	21
Cooper D	X			17
Cooper D		X	X	24
Cooper D		X		20
Cooper S	X		X	24
Cooper S	X			20
Cooper S		X	X	27
Cooper S		X		23

This may vary depending on the condition of the car and the equipment in it.

## Important information

These installation instructions are primarily designed for use within the MINI dealership organisation and by authorised MINI service companies.

In any event the target group for these installation instructions is specialist personnel trained on MINI cars with the appropriate specialist knowledge.

All work must be completed using the latest MINI repair manuals, wiring diagrams, servicing manuals and work instructions, in a rational order, using the prescribed tools (special tools) and observing current health and safety regulations.

**If you experience installation or function problems, restrict troubleshooting to approx. 0.5 hours for mechanical work and 1.0 hour for electrical work.**

To avoid unnecessary extra work and/or costs, send an inquiry straight away to the technical parts support team via the Aftersales Assistance Portal (ASAP).

Quote the following information:

- Chassis number,
- retrofit kit part number,
- detailed description of the problem,
- any work already carried out.

Do not archive the hard copy of these installation instructions since daily updates are provided via ASAP!

## Pictograms



Denotes instructions that draw your attention to dangers.



Denotes instructions that draw your attention to special features.



Denotes the end of the instruction or other text.

## **Installation information**

All pictures show LHD cars; proceed accordingly on RHD cars.

Keep the small parts (screws and expanding rivets) during removal. They will be required when installing the retrofit parts onto the car.

Keep the bumper cover somewhere safe after removal. It will be reused.

The fog lights and the PDC sensors are adopted from the car and simply installed on the retrofit parts in accordance with ISTA.

With MINI Cooper S variants, you should consult EBA 0129 155 612.

## **Ordering instructions**

Painted PDC sensors can be ordered via the EPC using MINI parts number: **66 20 0 393 938**. When ordering, the colour code must be specified.

For cars built after 08/10, the relevant conversion package must also be ordered in addition to the retrofit kit (for further details see EPC).

## **List of special equipment**

SA 507 PDC (Park Distance Control)

SA 322 Comfort access

## **Special tools required**

None

## **Painting instructions**

PDC sensors adopted from the car must not be painted over. Components do not have to be primed before painting. Follow the MINI painting instructions for all painting work.

Coarse parts are not painted.

## Table of contents

Section	Page
1. Entrance trim parts list .....	5
2. Front bumper parts list .....	6
3. Rear bumper parts list .....	7
4. Conversion package parts list for cars built after 08/10 (depending on design).....	8
5. Preparatory work .....	9
6. Completing the entrance trim.....	10
7. Completing the front bumper .....	13
8. Completing the rear bumper.....	16
9. Concluding work and coding (only cars with SA 507).....	19

## 1. Entrance trim parts list

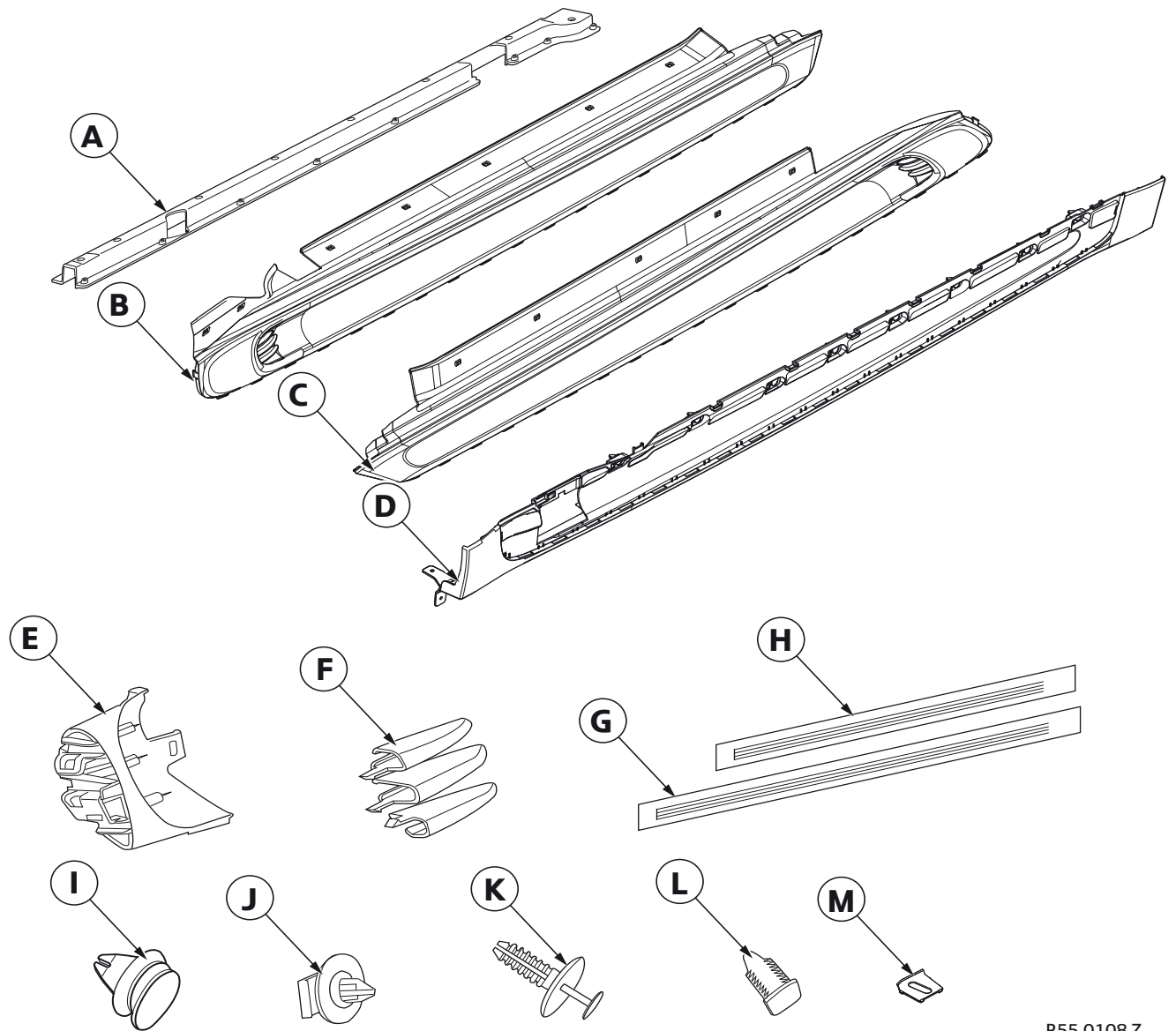

R55 0108 Z

### Legend

- A** Fastening adapter (2 x)
- B** Entrance trim, upper right section
- C** Entrance trim, upper left section
- D** Entrance trim, lower section (2 x)
- E** Side sill air inlet support section (2 x)
- F** Side sill air inlet insert (2 x)
- G** Right-hand sill trim
- H** Left-hand sill trim
- I** Black clip (18 x)
- J** White clip (4 x)
- K** Expanding rivet (18 x)
- L** Black clip (10 x)
- M** Striker cover

## 2. Front bumper parts list

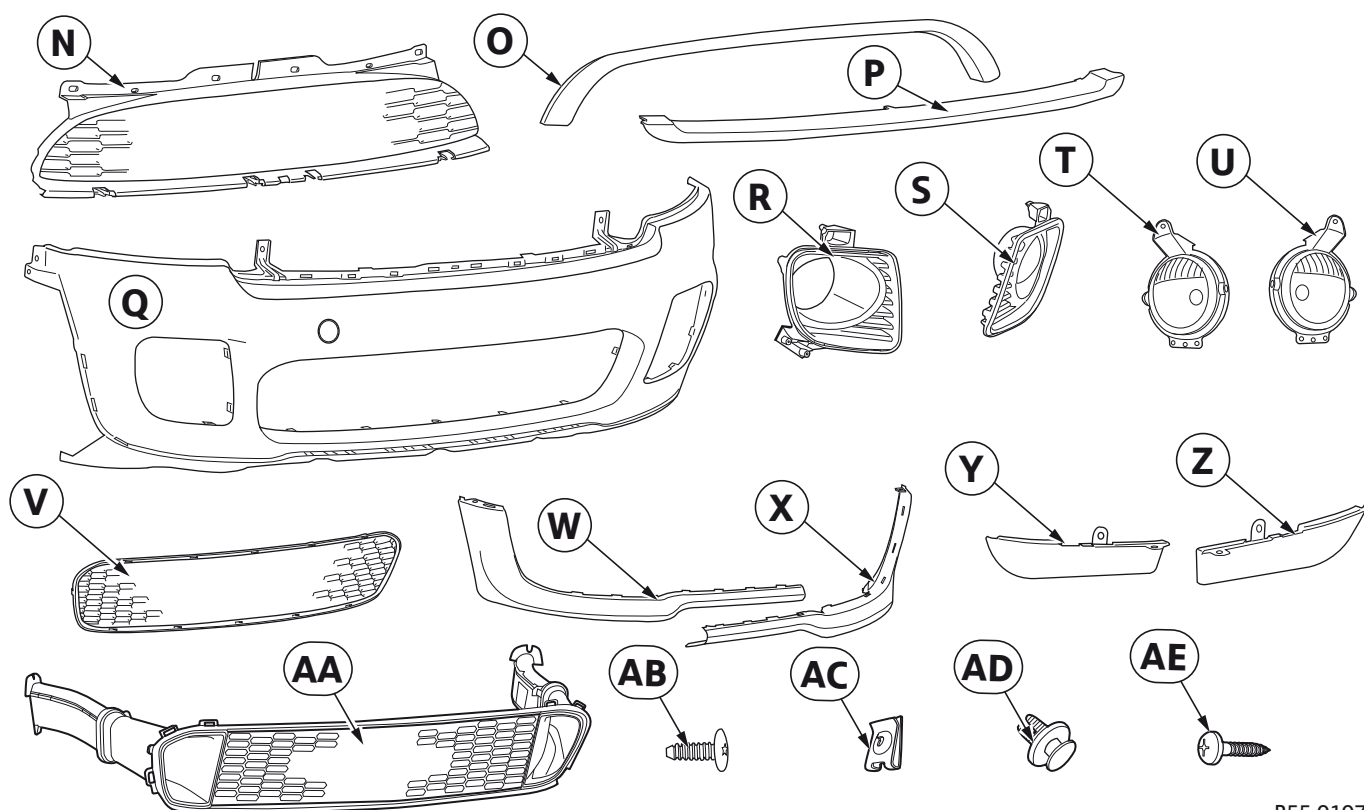

R55 0107 Z

### Legend

- N** Top air inlet grill
- O** Top air inlet cover
- P** Air inlet cover
- Q** Front bumper trim
- R** Right-hand fog light cover
- S** Left-hand fog light cover
- T** Right-hand fog light (adopted from the car)
- U** Left-hand fog light (adopted from the car)
- V** Bottom air inlet grill (not for Cooper S)
- W** Right flare
- X** Left flare
- Y** Right air guide
- Z** Left air guide
- AA** Brake air package (only for Cooper S)
- AB** Self-tapping screw (2 x)
- AC** Sheet metal nut (2 x)
- AD** Expanding rivet (4 x)
- AE** Screw (14 x)

### 3. Rear bumper parts list

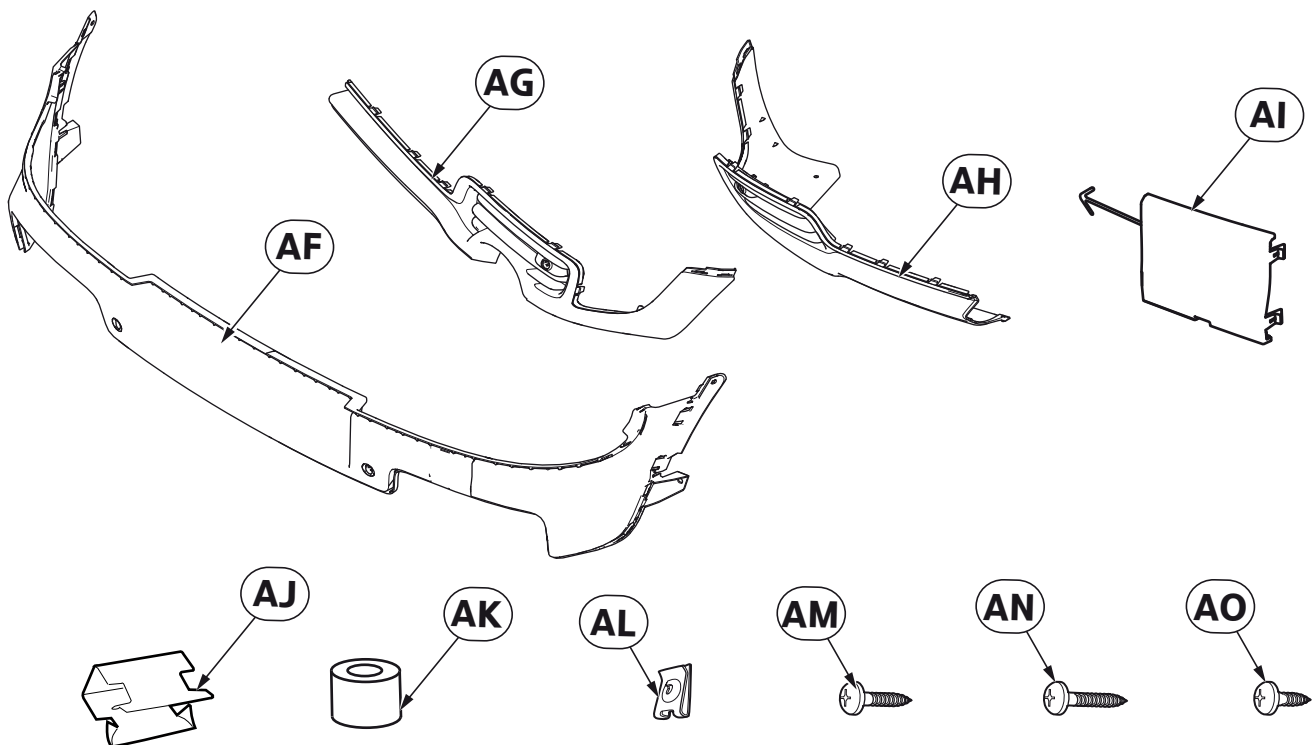

R55 0114 Z

#### Legend

- AF** Rear bumper trim
- AG** Rear bottom right cover
- AH** Rear bottom left cover
- AI** Towing eye cover
- AJ** Clip (2 x)
- AK** Spacer (2 x)
- AL** Sheet metal nut (3 x)
- AM** Screw L=20 mm
- AN** Screw L=30 mm (2 x)
- AO** Screw L=10 mm (2 x)

#### 4. Conversion package parts list for cars built after 08/10 (depending on design)

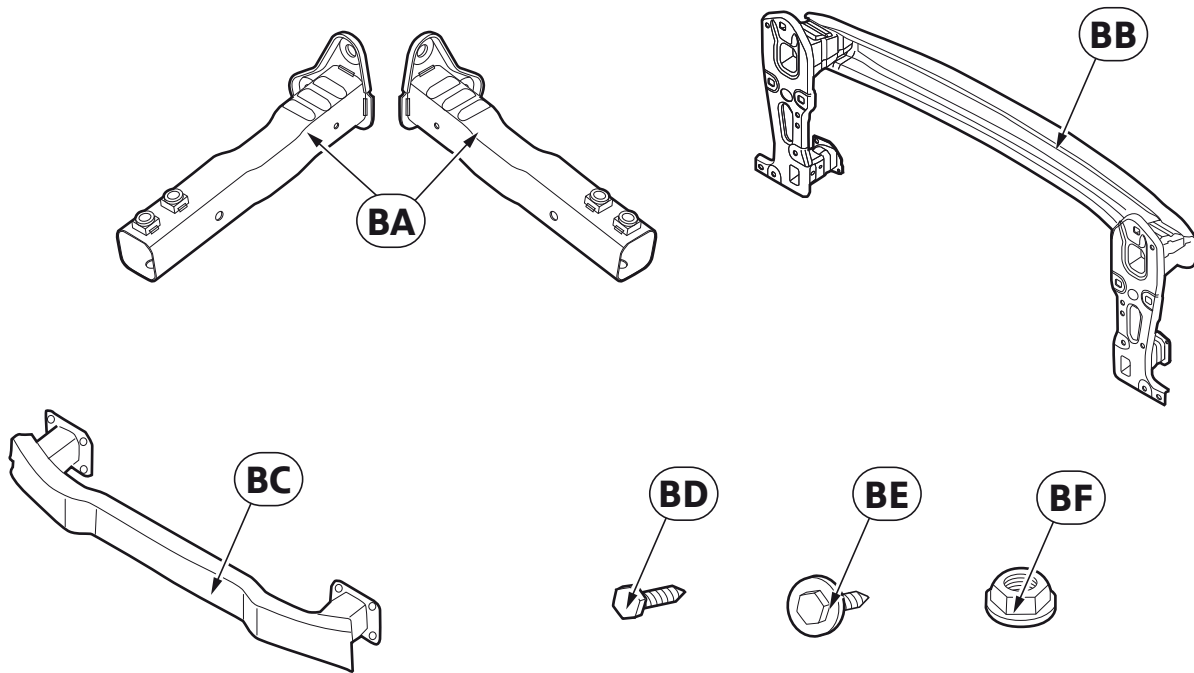

055 0125 V

#### Legend

- BA** Left/right bumper support mount (2 x)
- BB** Front bumper support
- BC** Rear bumper support
- BD** Hexagon screw (4 x)
- BE** Hexagon screw with flange (4 x)
- BF** Hexagon nut with washer (6 x)



## 5. Preparatory work

	<b>ISTA No.</b>
<b>First, the following components must be removed</b>	---
Remove the entrance trim	51 11 ...
Remove the front bumper	51 11 156
Remove the chrome strip for the air inlet grille	51 13 003
Remove the rear bumper	51 12 156
<b>For cars built after 08/10, the following must also be removed</b>	
Front bumper support	51 11 050
Front bumper support mount	51 11 050
Rear bumper support	51 12 050

## 6. Completing the entrance trim

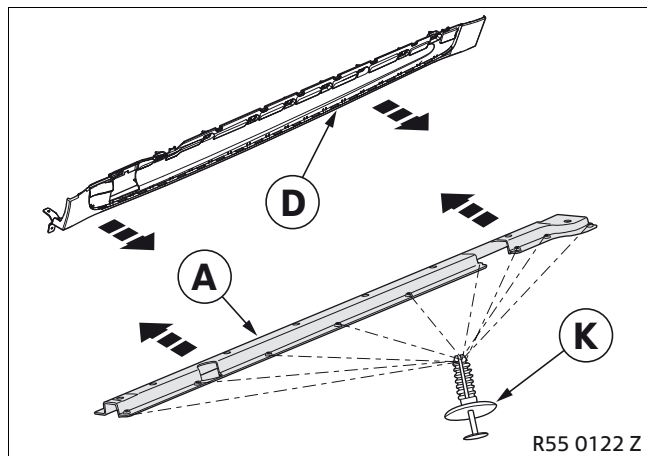

Place the fastening adapter **A** on the entrance trim, lower section **D**.

Place the expanding rivet **K** in the holes provided and lock into position.

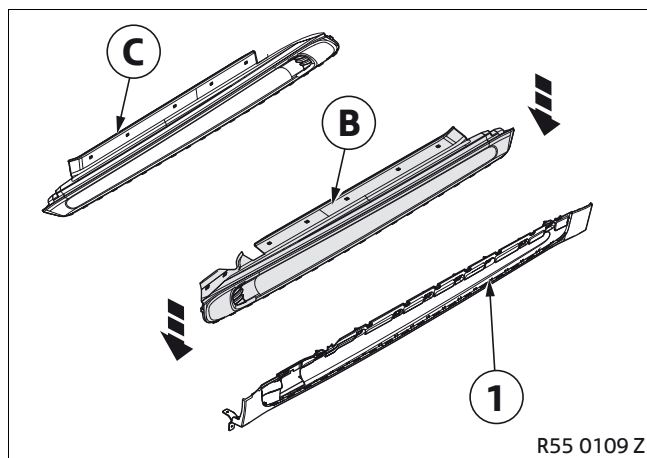

Place the entrance trim, right upper section **B** on the two previously-linked components (1) and allow to engage.

Fit the entrance trim, right upper section **C** in the same way.

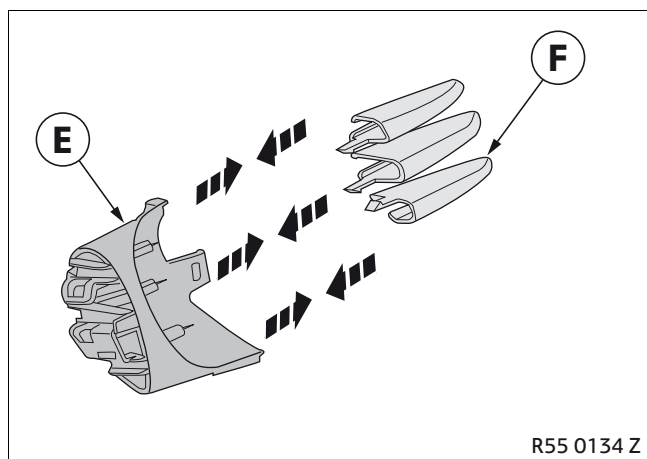

Plug the sill air inlet inserts **F** into the sill air inlet support section **E**.

The parts **F** are numbered and are inserted as follows:

- |                  |                   |
|------------------|-------------------|
| L1 – top left    | R1 – top right    |
| L2 – centre left | R2 – centre right |
| L3 – bottom left | R3 – bottom right |

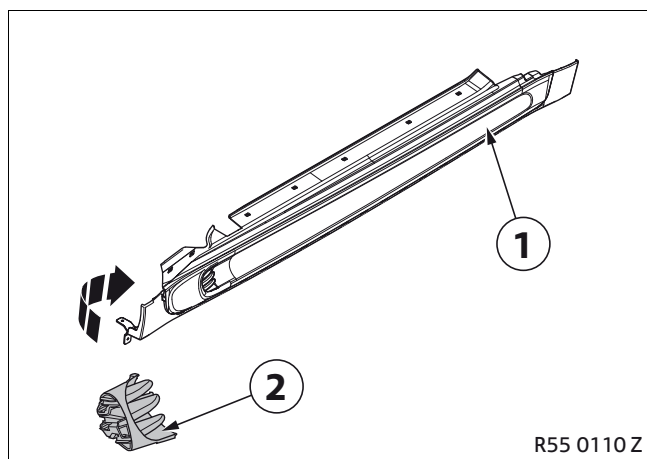

Insert the entire sill air insert (2) from the back of the entrance trim (1) into the cut-out opening and allow it to engage.

## 6. Completing the entrance trim insert

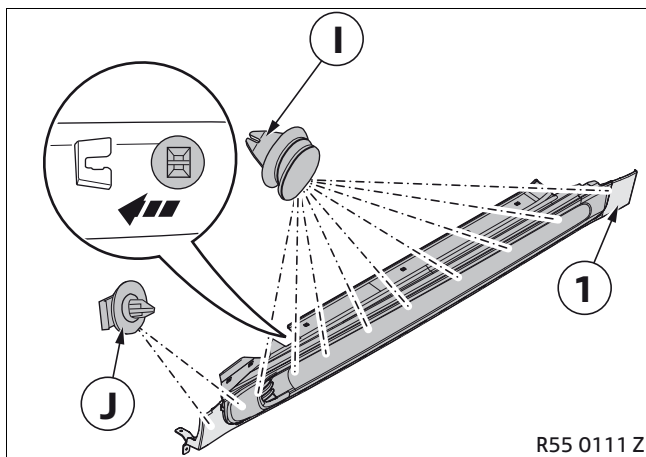

Push white clip **J** and black clip **I** into the retaining grooves provided on the back of the entrance trim (1).

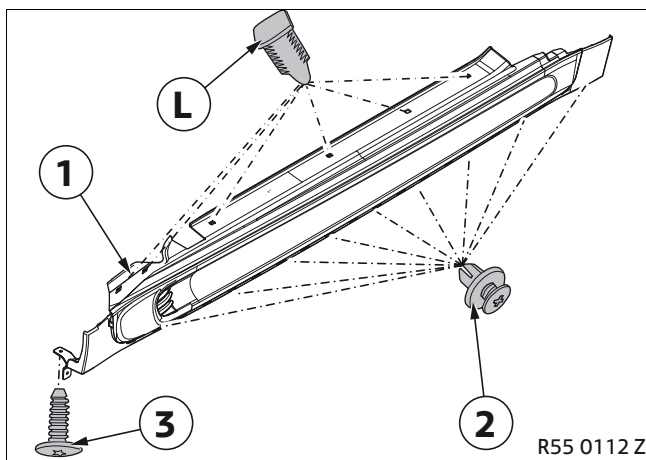

Fit the right entrance trim (1) onto the car with expanding rivets (2), Torx screws (3) and clip **L**.

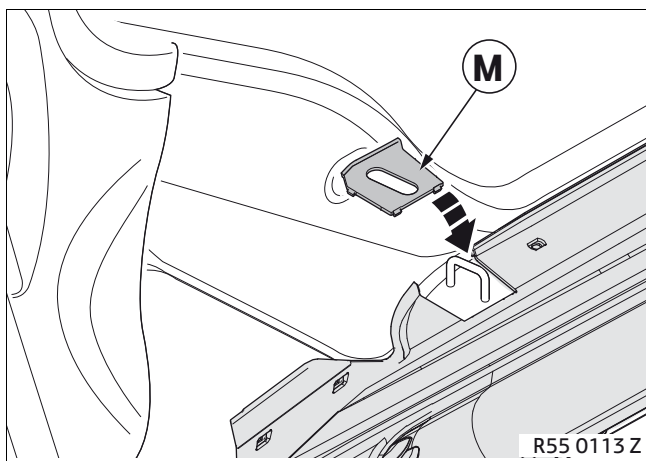

Engage the striker cover **M** in the entrance trim.

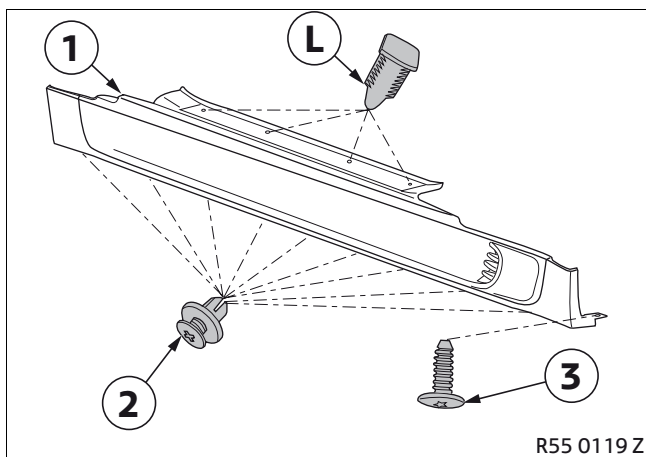

Fit the left entrance trim (1) onto the car with expanding rivets (2), Torx screws (3) and clip **L** as per ISTA.

## 6. Completing the entrance trim insert

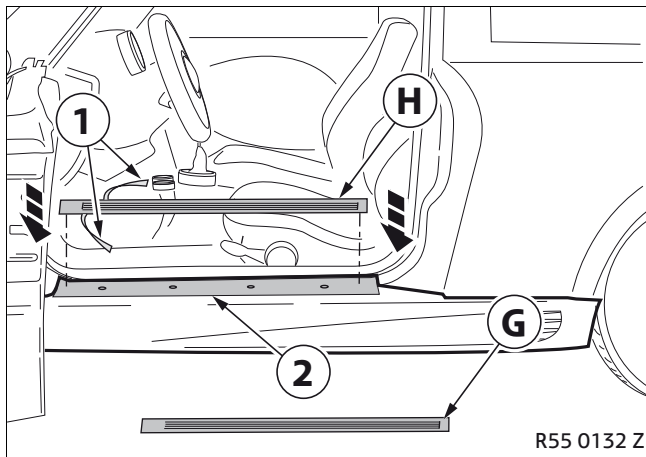

▶ Clean the adhesive surfaces as per BMW's instructions. ◀

Remove the protective film on the adhesive pads (1) from the underside of the sill cover **H**.

Place the sill cover **H** on the top of the entrance trim (2) and press firmly.

The illustration shows installation on the left-hand side. Proceed in a similar fashion on the right-hand side with cover **G**.

## 7. Completing the front bumper

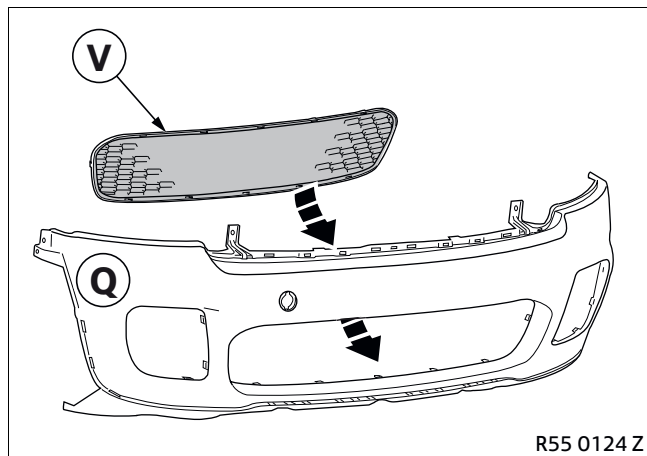

▶ For cars with a brake air channel, consult EBA 0129 2 155 612. ◀

Insert the lower air inlet grill **V** into the front bumper trim **Q** and allow it to engage.

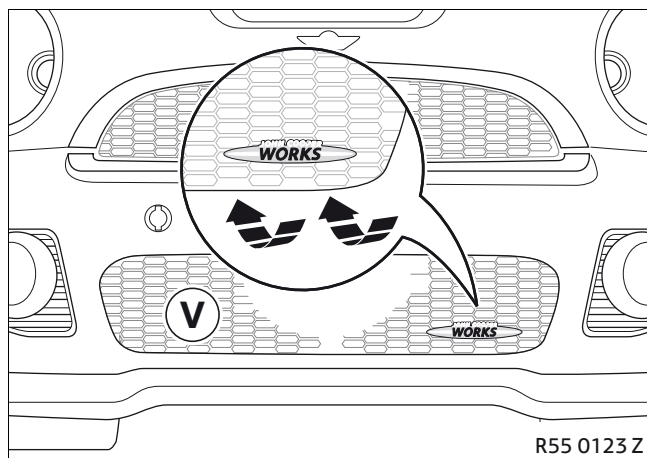

### Only for MINI Cooper JCW

The JCW logo is not supplied with the Aerodynamic package. It is only included with the JCW Tuning Kit or JCW special models.

The JCW logo on the lower air inlet grill **V** is screwed into place from behind, as shown.

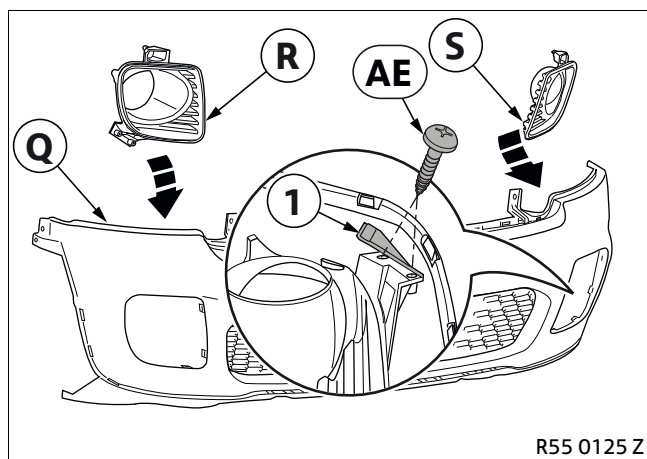

### All cars

Insert the right-hand fog light cover **R** and left-hand fog light cover **S** into the front bumper trim **Q** and engage.

Open the moulded-on hinge (1) on fog light cover **R/S** and secure with screws **AE**.

Remove the fog light from the series bumper trim and install into the front bumper trim **Q**.

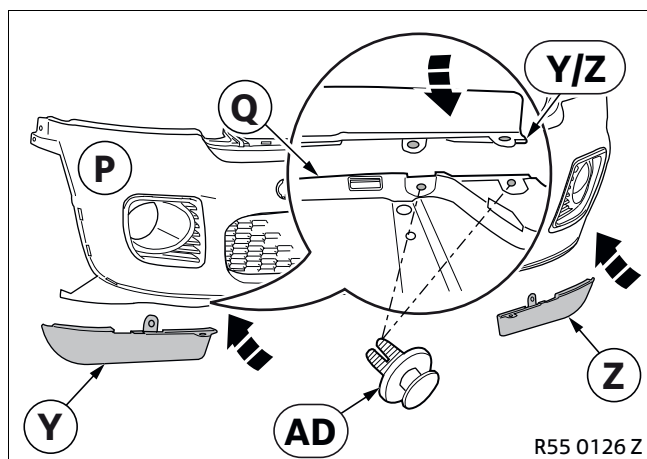

Place right-hand air guide **Y** and left-hand air guide **Z** on the underside of front bumper trim **Q** and secure with expanding rivet **AD**.

## 7. Completing the front bumper

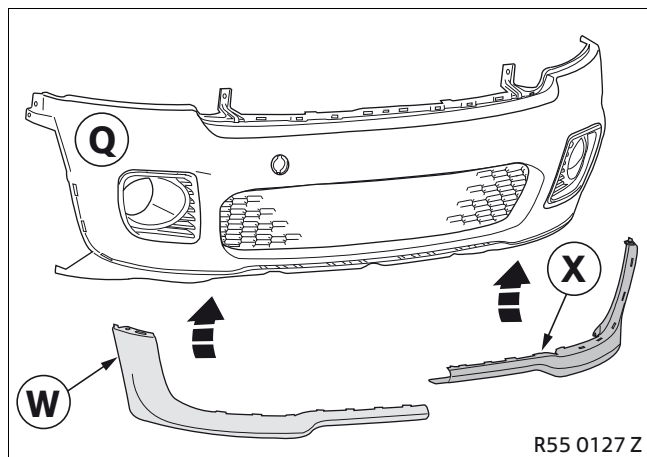

Place right flare **W** and left flare **X** on the underside of front bumper trim **Q** and engage.

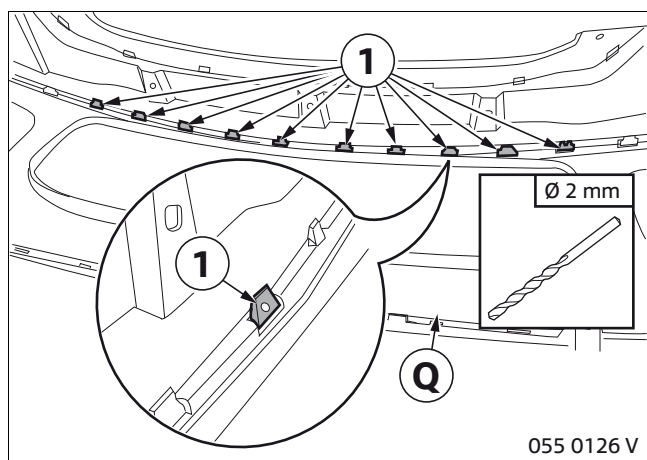

Drill through the 10 locking lugs (1) on front flare **W** and **X** using a **2 mm-diameter** drill bit through locking lug (1) and into front bumper trim **Q**.

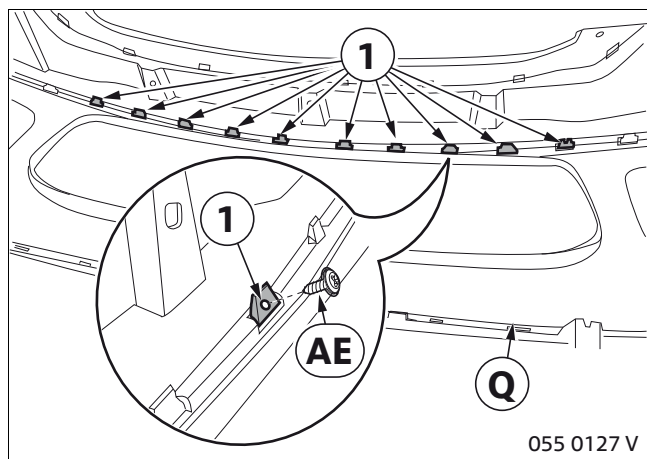

Securely fasten the 10 locking lugs on front flare **W** and **X** using self-tapping screws **AE** to front bumper trim **Q**.

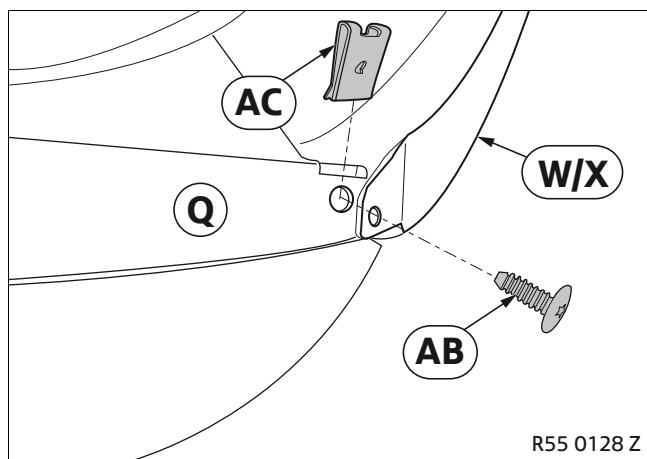

Place sheet metal nut **AC** in the mounting point on front bumper trim **Q**. Secure right-hand flare **W** and left-hand flare **X** using sheet metal screw **AB** to front bumper trim **Q**.

## 7. Completing the front bumper

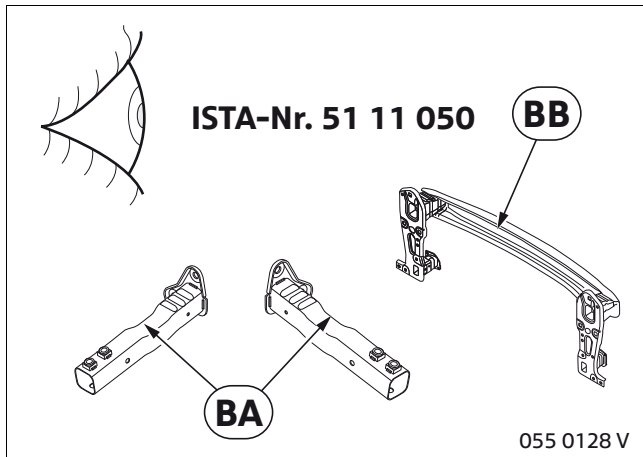

### Cars built after 08/10 only

Fit front bumper support **BB** and front bumper mount **BA** using the enclosed fastening parts from the conversion package (which must be ordered separately) as per ISTA.

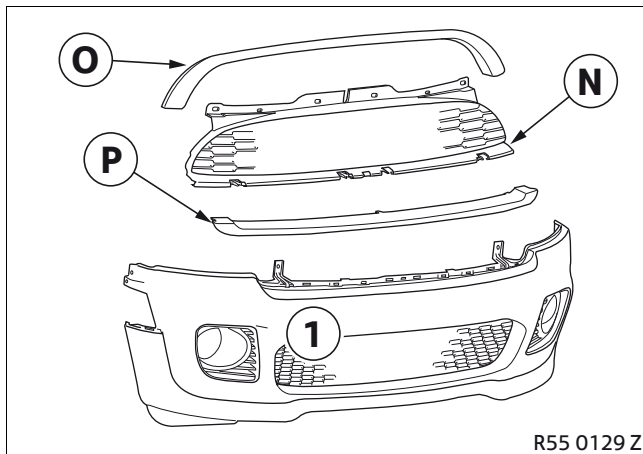

Fit the pre-fitted front bumper trim (1) and the top air inlet grill **N** and the top air inlet cover **P** onto the car.

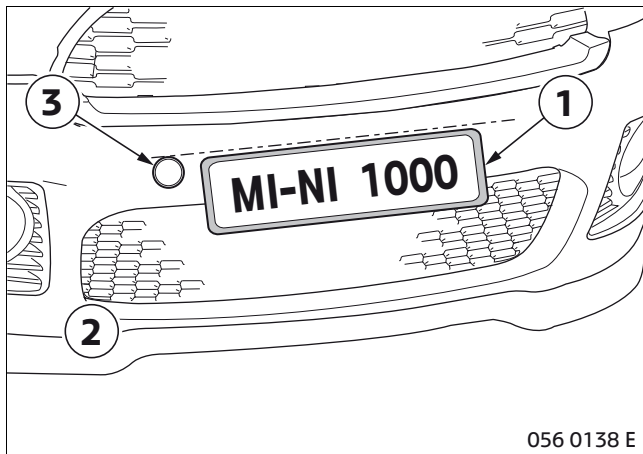

The licence plate (1) is aligned with the bumper (2) using the upper border of the towing hook opening (3).

## 8. Completing the rear bumper

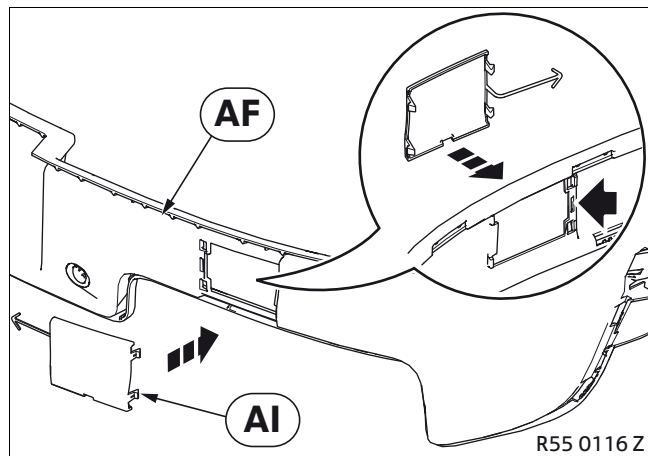

### All cars

Guide the barb of the towing eyelet cover **AI** through the opening and engage it in rear bumper trim **AF** and check it is secure.

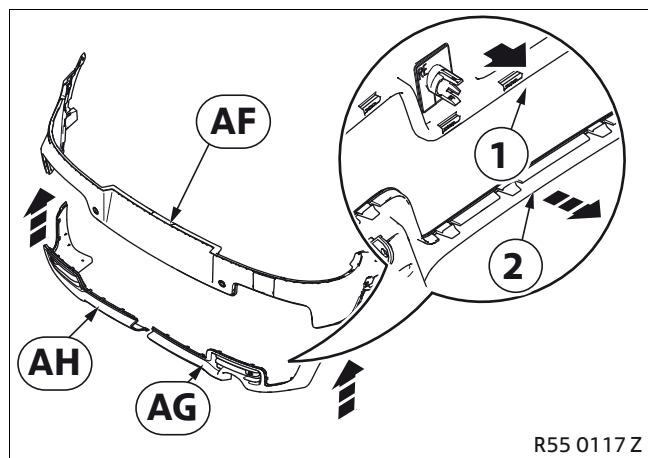

Ensure that the fastening points (1) and (1) are not bent. ◀

Allow the rear bottom left cover **AH** and rear bottom right cover **AG** to engage in the rear bumper trim **AF**.

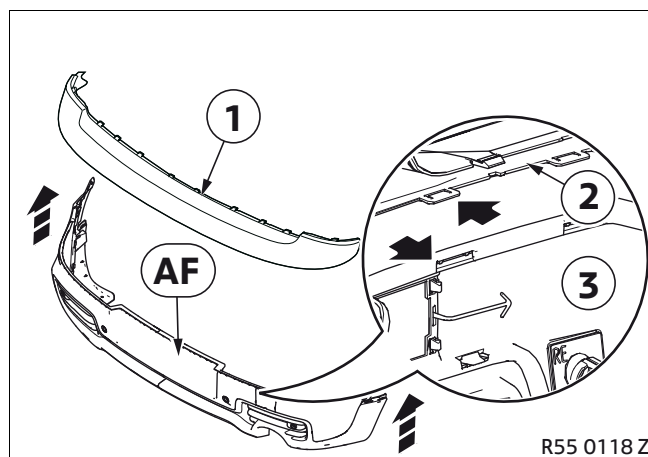

Ensure that the fastening points (1) and (2) are not bent. ◀

Engage the rear bumper cover (1) in the rear bumper trim **AF**.

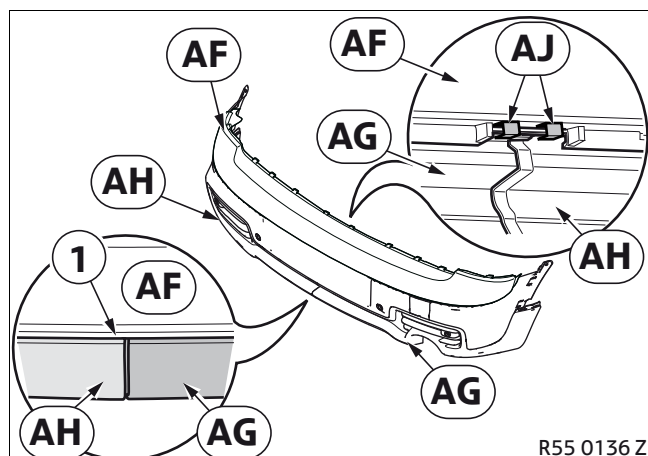

Ensure that the gap (1) between the bottom rear left cover **AH**, bottom rear right cover **AG** and rear bumper trim **AF** is the same along its entire length and that covers **AG** and **AH** do not extend beyond it. ◀

Secure rear bottom left cover **AH** and rear bottom right cover **AG** with clips **AJ** to rear bumper trim **AF**.



## 8. Completing the rear bumper

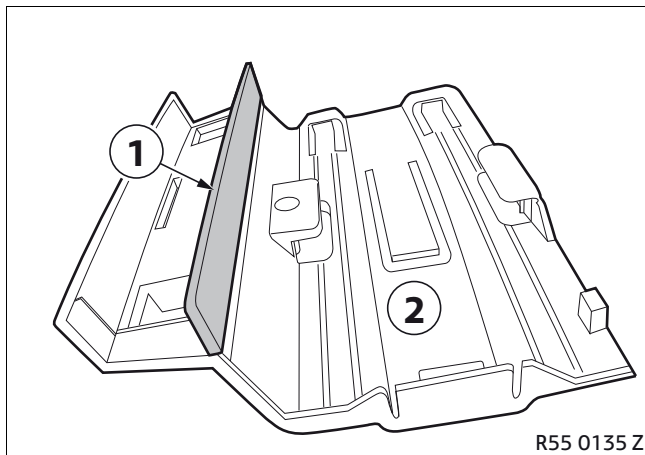

### Cars with SA 322 only

Separate the marked area (1) on the Comfort access antenna mount (2).

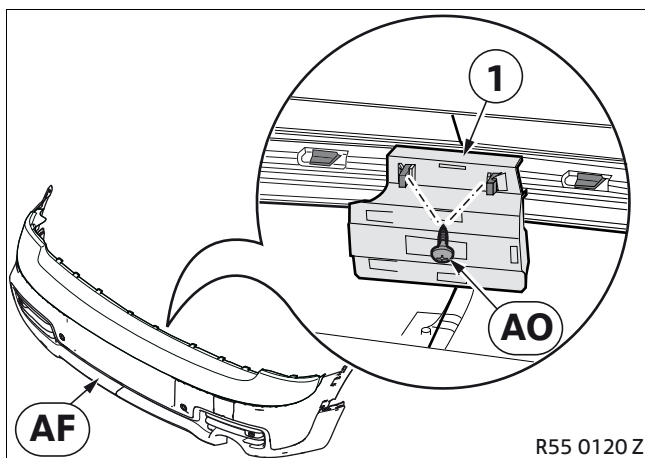

Secure Comfort access antenna (1) to rear bumper trim **AF** by inserting screws **AO** sideways and fastening them.

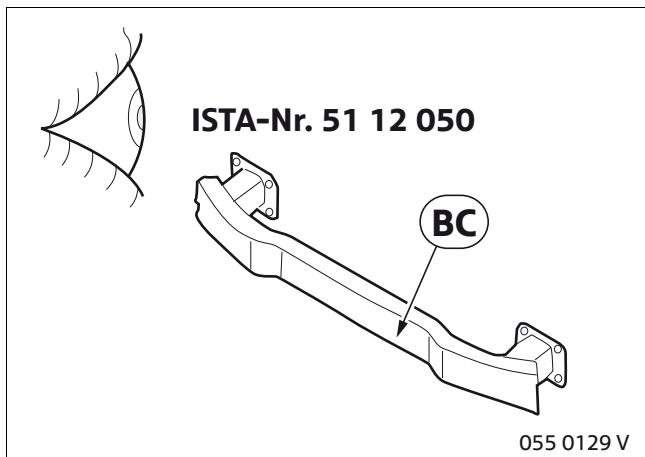

### Cars built after 08/10 only

Fit front bumper support **BC** using the enclosed fastening parts from the conversion package (which must be ordered separately) as per ISTA.

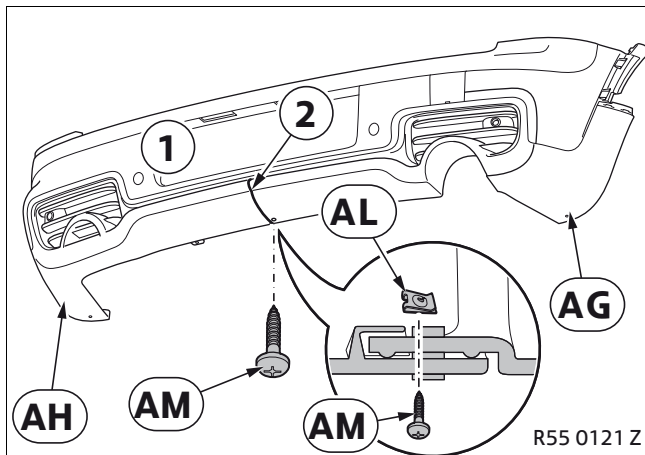

### Cars with SA 507 only

Insert the PDC sensors into the bumper trim (1).

### All cars

Secure the pre-fitted bumper trim (1) to the car.

Align the gap (2) parallel (2-3 mm) and drill a hole of diameter 4 mm on the marking through rear bottom right cover **AG** and rear bottom left cover **AH**.

Insert screw **AM** and secure with sheet metal nut **AL**.

## 8. Completing the rear bumper

 Note the design of the bumper trim (1). ◀

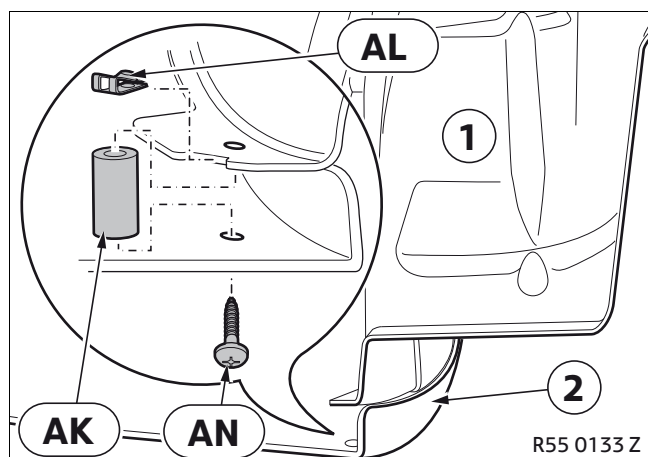

### Design 1

Place sheet metal nut **AL** on the wheel arch panel.

Connect the bumper trim (1) and wheel arch panel (2) using screw **AN** and spacer **AK**.

The illustration shows installation on the left-hand side. Proceed in a similar fashion on the right-hand side.

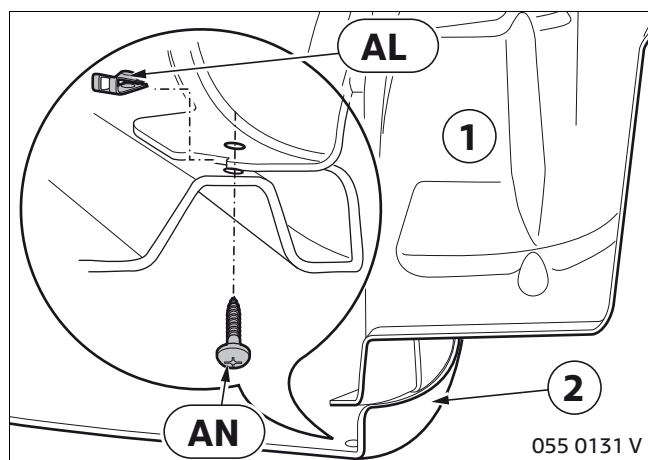

### Design 2

Place sheet metal nut **AL** on the wheel arch panel.

Connect the bumper trim (1) and wheel arch panel (2) using screw **AN**.

The illustration shows installation on the left-hand side. Proceed in a similar fashion on the right-hand side.

## **9. Concluding work and coding (only cars with SA 507)**

This retrofit system requires coding.

- Program/encode the retrofit with ISSS (Integrated Software Service Station) via the – Retrofit, John Cooper Works Aerodynamic package – path
- Conduct a brief test
- Function test