

ORIGINAL MINI PARTS AND ACCESSORIES. INSTALLATION INSTRUCTIONS.



JOHN COOPER WORKS Silencer System Retrofit Kit.

MINI Clubman (F54)

MINI Countryman (F60)

Retrofit kit number

18 30 2 450 807	Silencer system F54 JOHN COOPER WORKS US built before 07/19
18 30 2 450 808	Silencer system F60 JOHN COOPER WORKS US built before 07/19
18 30 2 473 538	Silencer system F54, F60 Cooper S AWD US built after 07/19
13 30 2 473 539	Silencer system F54, F60 Cooper S FWD US built after 07/19

Installation time

The installation time is **approx. 3.0 hours**. This may vary depending on the condition of the car and its equipment package.

The installation time shown does not include any time spent on programming/coding.

The calculation of the total costs for the programming time must be factored into the calculation of retrofitting costs (must not be invoiced under the warranty).

Important information

These installation instructions are primarily designed for use within the MINI dealership organisation and by authorised MINI service companies.

In any event the target group for these installation instructions is specialist personnel trained on MINI cars with the appropriate specialist knowledge.

All work must be completed using the latest MINI repair manuals, wiring diagrams, servicing manuals and work instructions, in a rational order, using the prescribed tools (special tools) and observing current health and safety regulations.

If you experience installation or functional problems, restrict troubleshooting to approx. 0.5 hours for mechanical work and 1.0 hour for electrical work.

To avoid unnecessary extra work and/or costs, send an inquiry straight away to the technical parts support team via the Aftersales Assistance Portal (ASAP).

Quote the following information:

- VIN,
- retrofit kit part number,
- a detailed description of the problem,
- any work already carried out.

Do not archive the hard copy of these installation instructions, since daily updates are supplied in ASAP!

Pictograms

 Denotes instructions that draw your attention to dangers.

 Denotes instructions that draw your attention to special features.

◀ Denotes the end of the instruction or other text.

Installation information

Ensure that the cables and/or lines are not kinked or damaged as you install them in the car. Costs incurred by this will not be reimbursed by BMW AG.

Additional cables/wires that are installed must be secured with cable ties. If the specified PIN chambers are occupied, bridges, double crimps, or twin-lead terminals must be used.

All illustrations show LHD (left-hand drive) cars; proceed similarly on RHD (right-hand drive) cars.

Some of the installation work is shown only on the F60. Proceed in the same way on the other cars.

Remote control

The silencer remote control **E** must be given to the customer along with its packaging and its function explained.

List of special equipment

The following special equipment must be taken into consideration when installing the retrofit kit:

SA 4VA MINI Driving Modes

Special tools required

17 2 051, no information

Table of contents

Section	Page
1. Silencer system parts list	4
2. Preparatory work	5
3. Install the wiring harness	6
4. Silencer system installation	9
5. Dummy flap actuator installation (for F54, F60 JOHN COOPER WORKS cars only)	10
6. Concluding work	11

1. Silencer system parts list

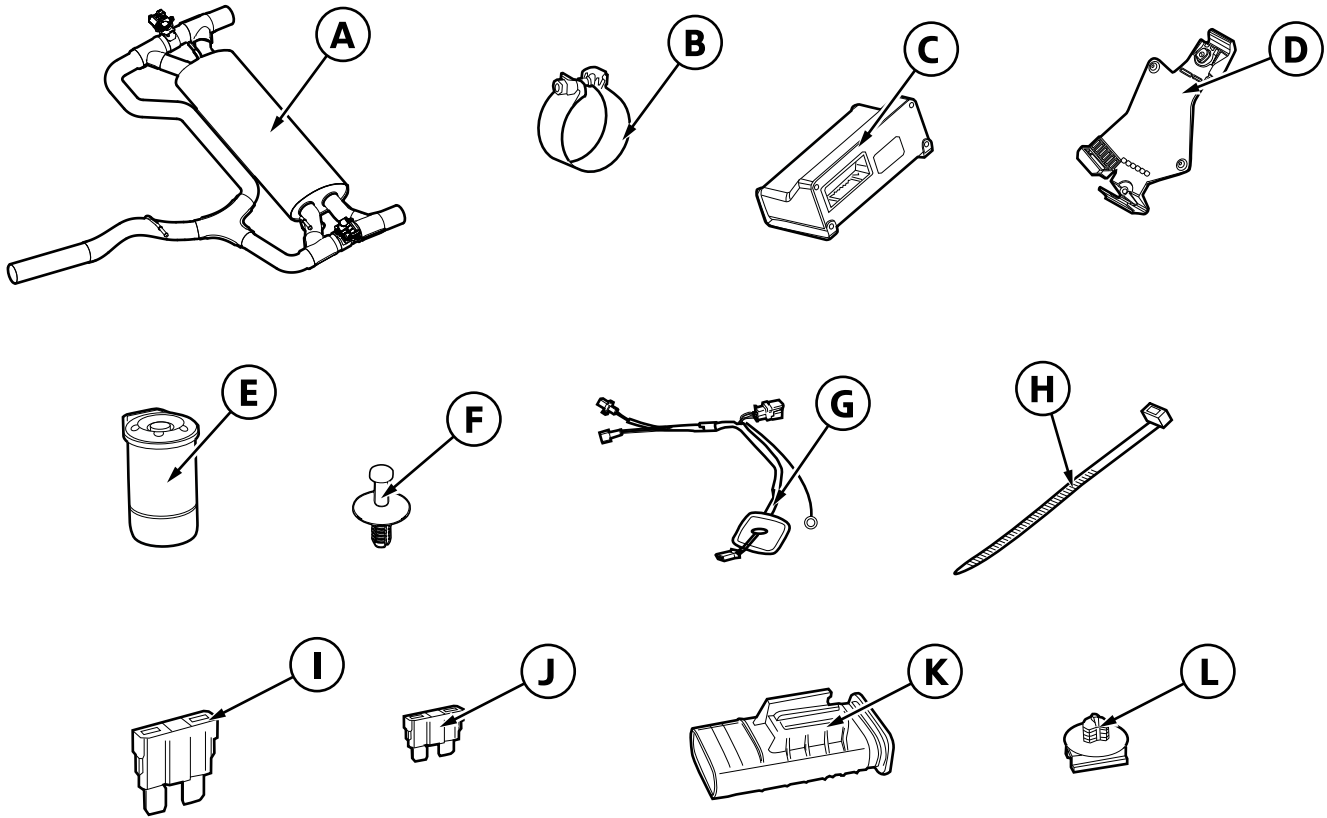

F60 0030 V

Legend

- A** Silencer
- B** Clamping ring
- C** Silencer receiver unit
- D** Receiver unit mounting (**for F54 cars without SA 4VA only**)
- E** Silencer remote control (including packaging)
- F** Plastic rivet (3 x, **for F60 cars only**)
- G** Silencer wiring harness
- H** Cable ties (3 x)
- I** Fuse 5 A
- J** Miniature fuse 5 A
- K** Dummy flap actuator (**for F54, F60 JOHN COOPER WORKS cars only**)
- L** Retaining clip

2. Preparatory work

	ISTA/AIR No.
Disconnect the negative battery cable	12 00 ...
The following components must be removed first of all	
Finisher on the top tail panel	51 46 050
Luggage compartment floor trim	51 47 101
Luggage compartment wheel arch trim panels, left and right	51 47 161
Rear right side trim panel	51 43 002
Rear right door sill cover strip	---
Side footwell trim on right B pillar	---
Front right sill cover strip	51 47 000
Side footwell trim on right A pillar	51 43 075
Disengage the front power distribution box	61 14 ...
Exhaust system from standard separation point	18 00 018

3. Install the wiring harness

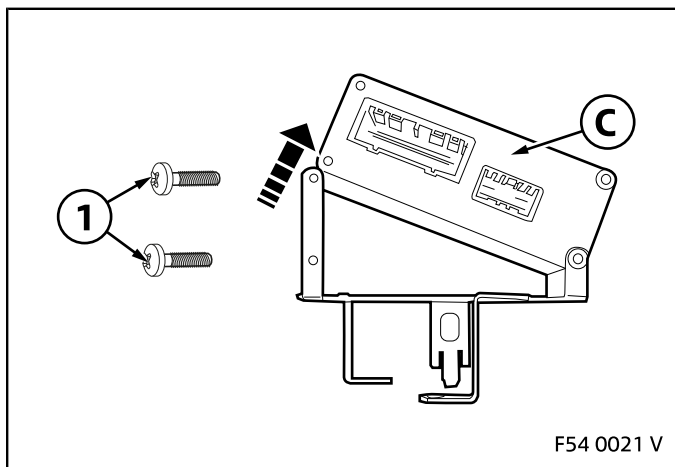

For F54 cars only

Undo the two screws (1) from the silencer receiver unit **C** and keep them safe. Turn the silencer receiver unit **C** upwards as shown in the figure.

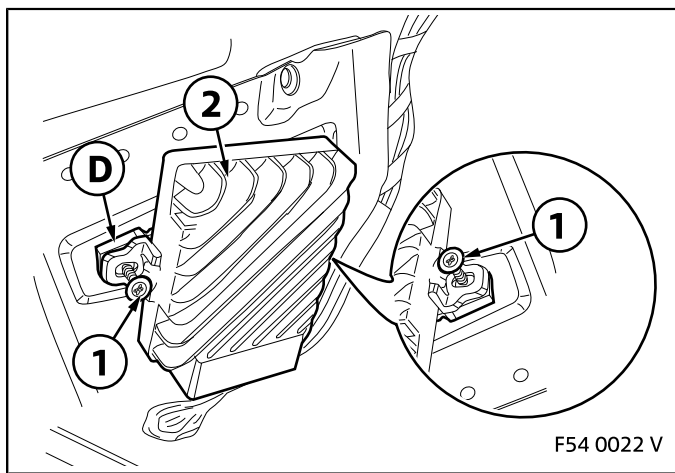

For F54 cars with SA 4VA only

☒ Cars with **SA 4VA** already have a control unit with the receiver unit mounting **D** on the left side of the boot. ◀

Unscrew the two screws (1) on the control unit (2). Then unclip the receiver unit mounting **D**.

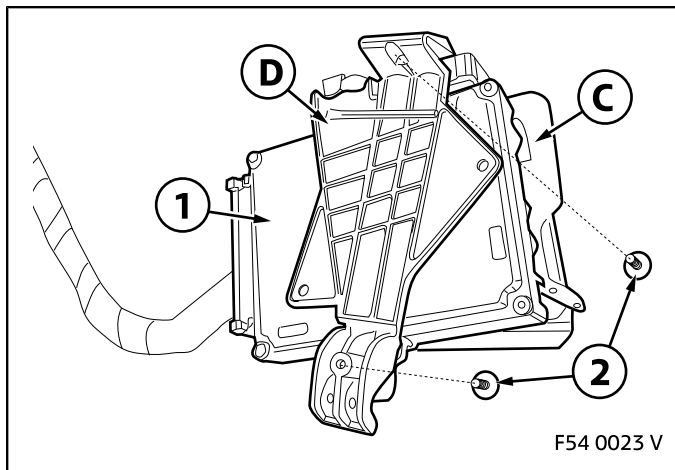

For all F54 cars

Fasten the receiver unit mounting **D** to the rear of the control unit (1). Fasten the silencer receiver unit **C** to the control unit (1) from the front. Turn the two existing screws (2) into the boreholes in the receiver unit mounting **D** from the front until they grip. Do not screw them in completely.

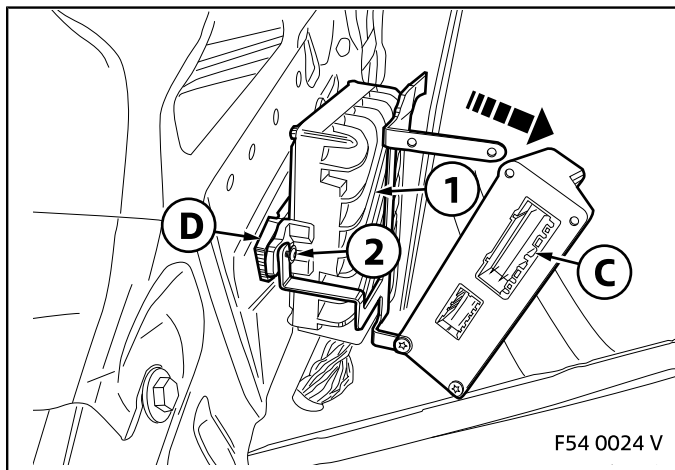

Clip the receiver unit mounting **D** back onto the car.

☒ To make the screw (1) easier to access, push down the silencer receiver unit **C** as far as possible. ◀

Then secure both screws (1) and (2) using a suitable tool.

3. Install the wiring harness

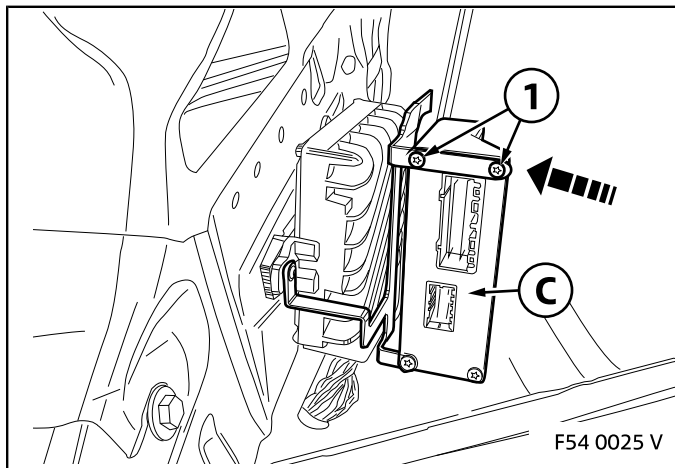

Unscrew the silencer receiver unit **C** and secure it with the two existing screws (1).

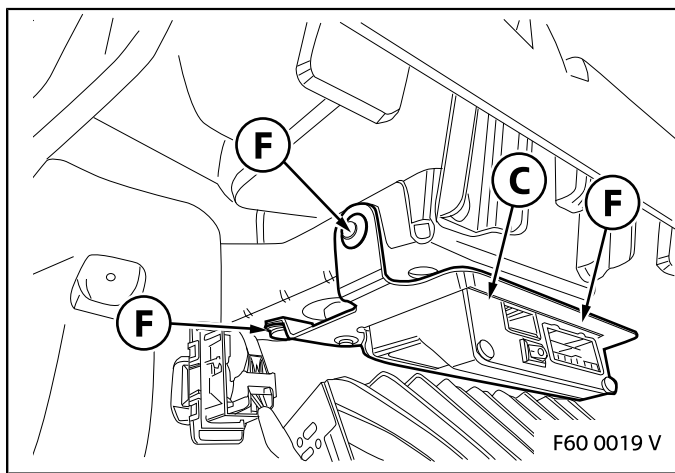

For F60 cars only

Secure the silencer receiver unit **C** with the three plastic rivets **F** to the left hand side of the boot above the amplifier as shown. One of the two rear plastic rivets **F** is not shown in the figure.

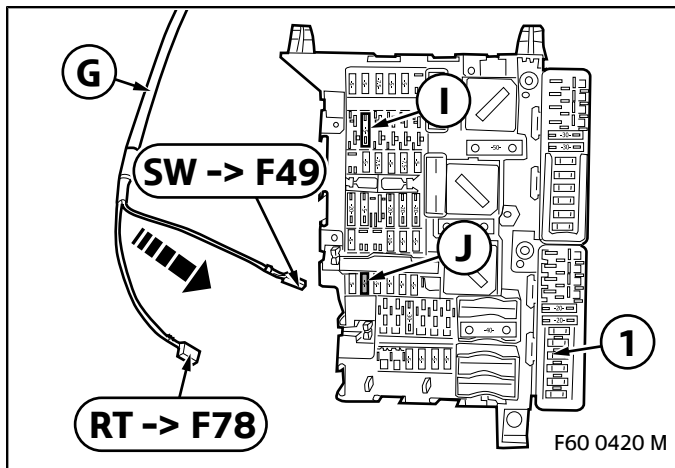

For all cars

Connect the red cable (**RT**) from the wiring harness **G** to fuse plug **F78** in the front power distributor (1). Insert the fuse **I** into slot **F78** (terminal 30B).

Connect the black cable (**SW**) from the wiring harness **G** to fuse plug **F49**. Insert the miniature fuse **J** into slot **F49** (terminal 15N).

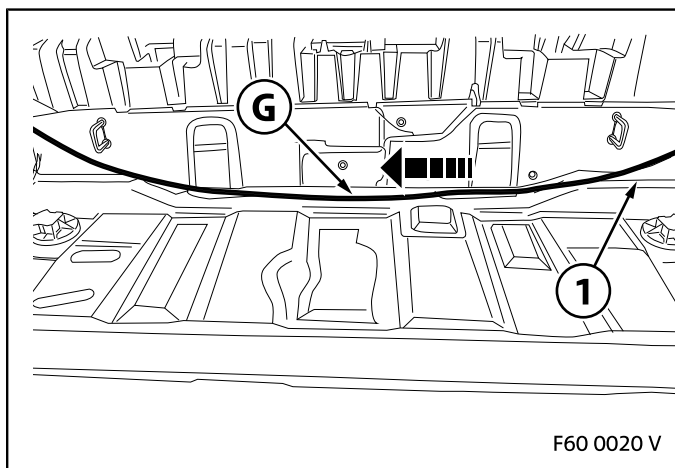

Route the wiring harness **G** to the rear of the boot and secure it in a suitable position with cable ties **H**. Then route the wiring harness **G** from the right to the left side along the boot edge (1).

3. Install the wiring harness

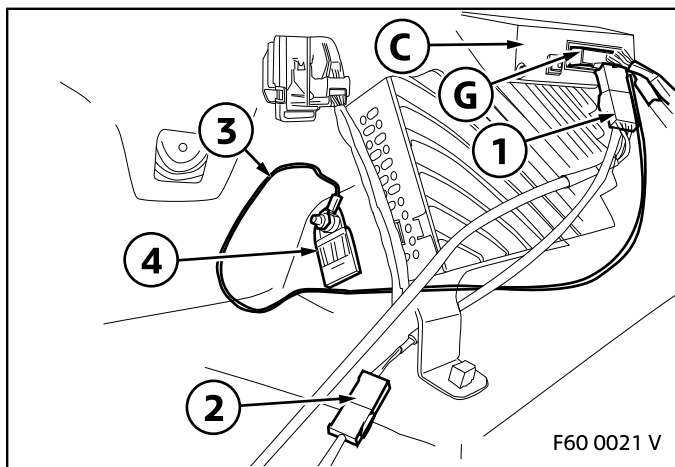

Connect the wiring harness **G** to the silencer receiver unit **C**.

Disconnect the two plugs (1) and (2) from the wiring harness **G**.

Secure the earth cable (3) to the car's ground support point (4).

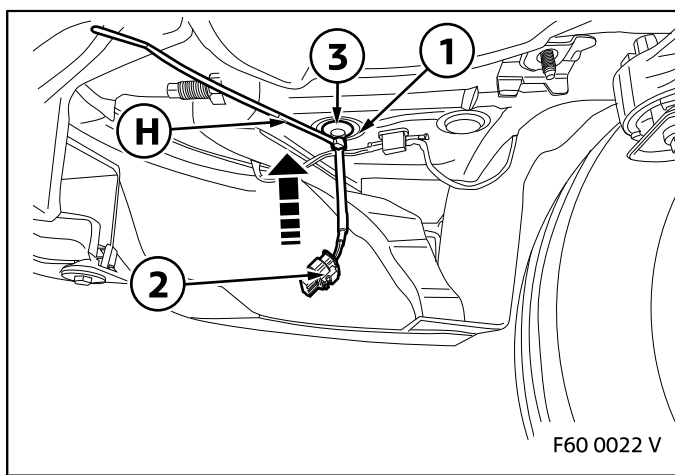

▶ Install the short silencer cable on the left of the car. Install the long silencer cable on the right of the car. ◀

Open the borehole (1) using a suitable tool. Route the removed silencer cable (2) from below through the opening up to the cable retaining bung (3). Insert the retaining bung and then secure it to prevent it sliding with a cable tie **H**.

Repeat the process on the opposite side.

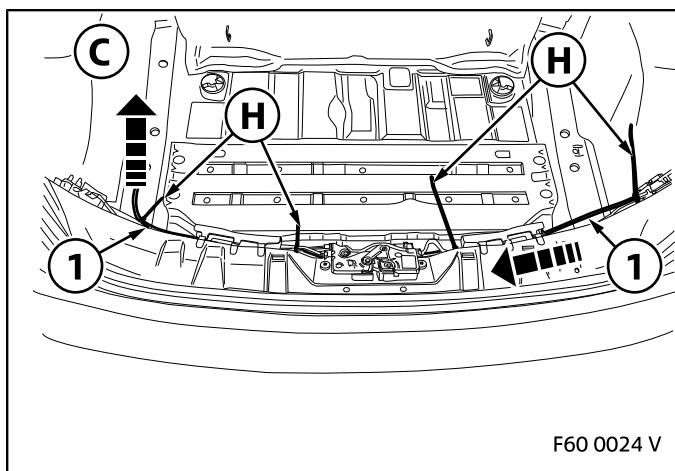

Route the silencer cable (1) from right to left and secure it to the edge of the boot floor with cable ties **H**. Route both silencer cables towards the receiver unit **C** (not shown) and secure them with a cable tie **H**.

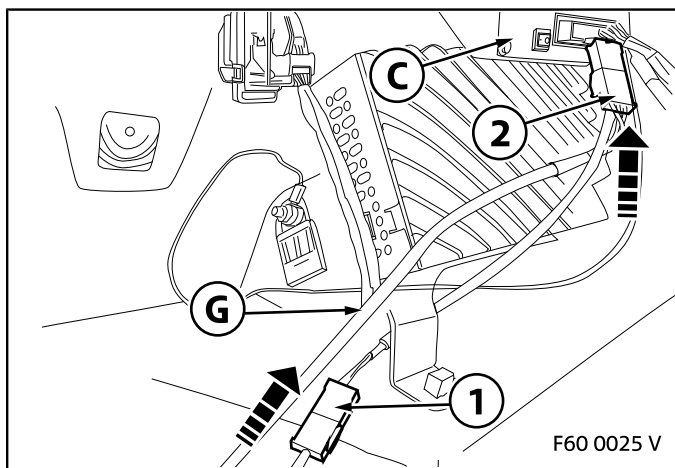

Reconnect the two plugs (1) and (2) on wiring harness **G** to the two sockets on the silencer receiver unit **C**. Connect the shorter silencer cable (2) to the shorter cable and the longer silencer cable (1) to the longer cable.

4. Silencer system installation

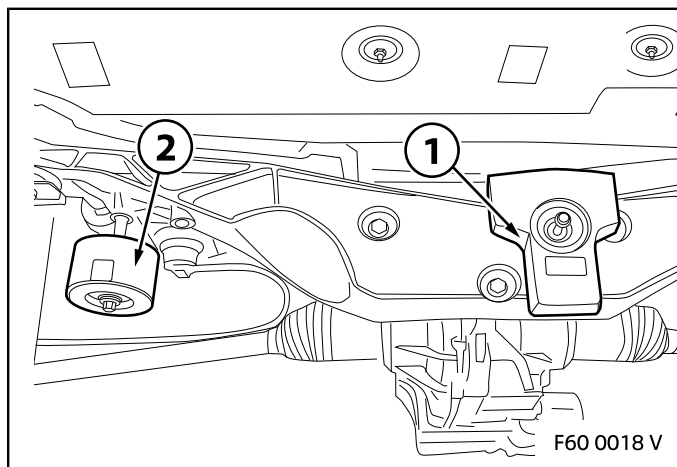

Cars with automatic transmission only

Remove the two vibration absorbers (1) and (2), they are no longer required.

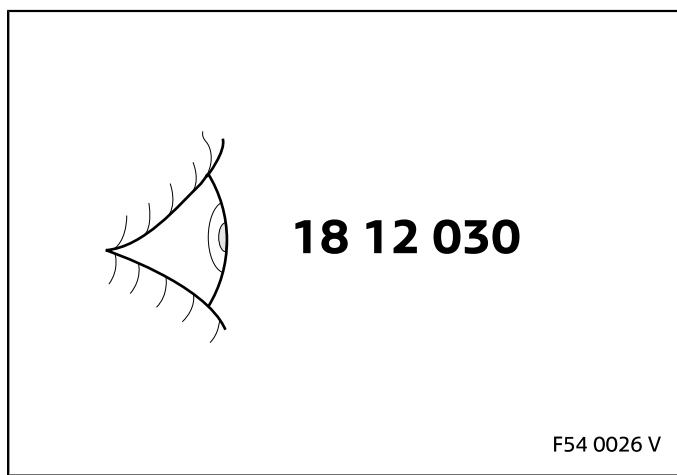

For all cars

Install the silencer **A** as described in **ISTA/AIR No. 18 12 030**.

5. Dummy flap actuator installation (for F54, F60 JOHN COOPER WORKS cars only)

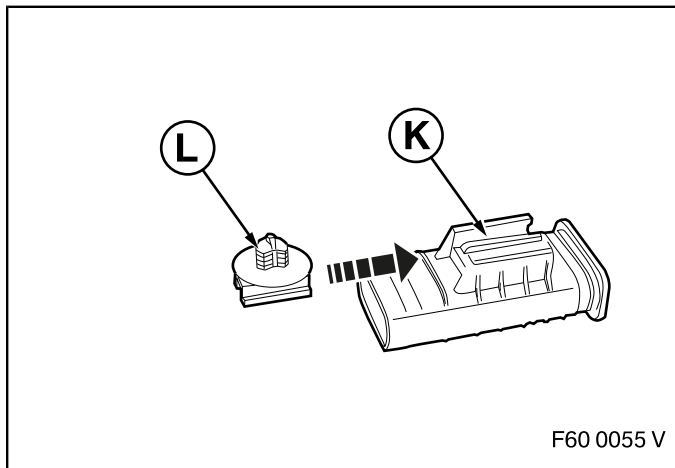

Attach the retaining clip **L** to the guide on the dummy flap actuator **K**.

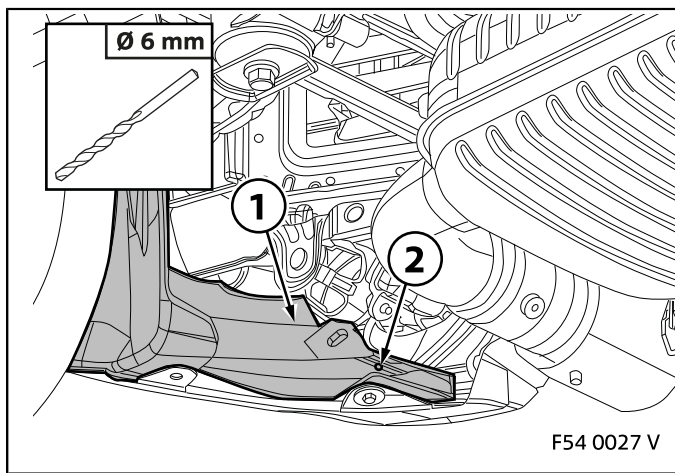

For F54 cars only

Drill a hole (2) with a **diameter of 6 mm** at the location shown in the rear left bumper support (1).

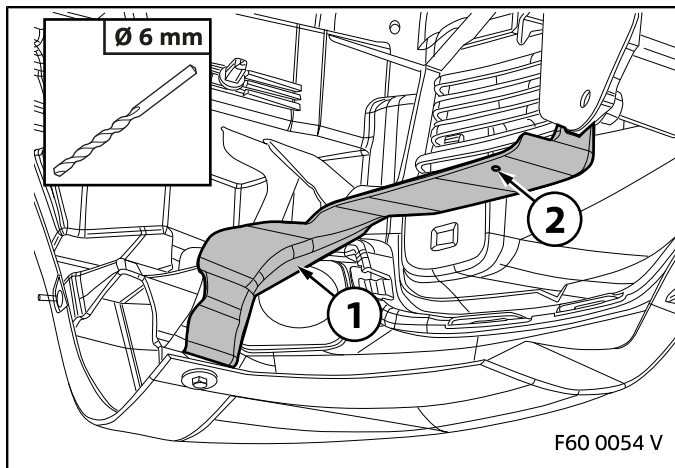

For F60 cars only

Drill a hole (2) with a **diameter of 6 mm** at the location shown in the rear left bumper support (1).

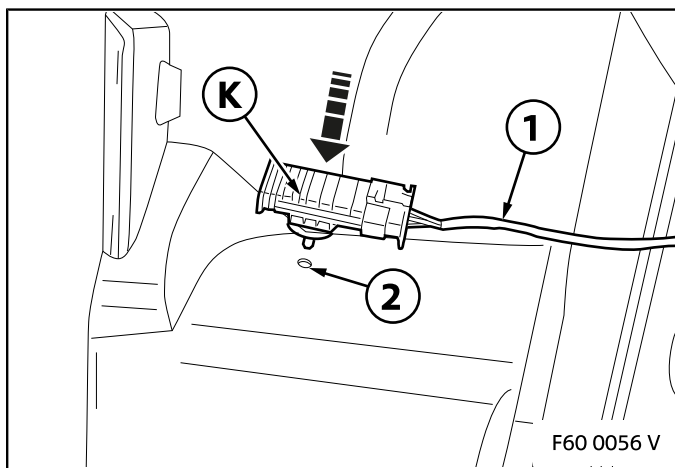

For all cars

Connect the dummy flap actuator **K** to the standard cable (1) for the flap control. Route the standard cable (1) along a suitable point and attach the dummy flap actuator **K** from the inside to the borehole (2).

6. Concluding work

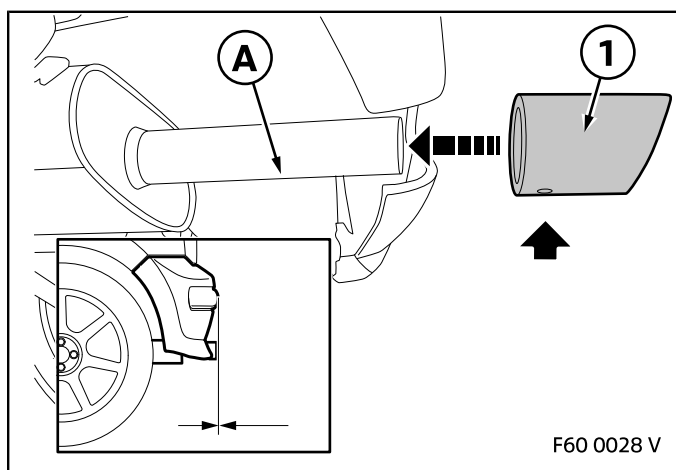

▶ The exhaust pipe trims (1) must be aligned centrally and parallel and must not extend beyond the bodywork parts above them. ◀

Align the exhaust pipe trims (1) flush with the bodywork parts situated above them and tighten them with a torque of **3 Nm**.

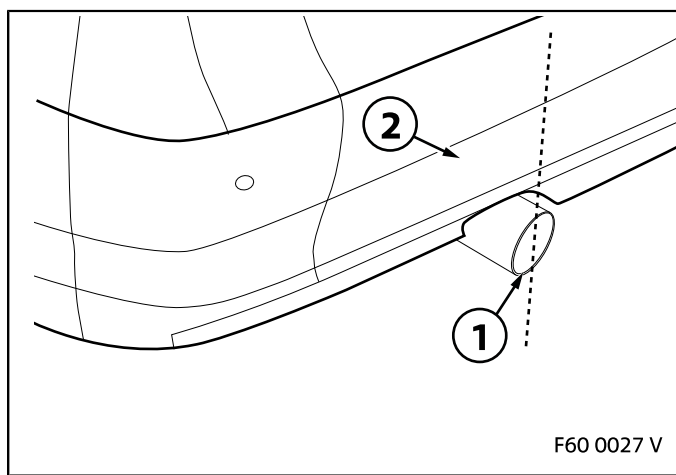

▶ During installation and also during vehicle use (thermal expansion of the exhaust system), care must be taken to ensure that the tailpipe trim (1) does not extend beyond the rear apron (2). Danger of burn damage! ◀

– Re-assemble the car